

Rookwood Necropolis

Management Unit Policies

Referenced Document to the
Plan of Management 2014



Rookwood

February 2014
DEM (Aust) Pty Ltd

The Management Unit Policies form the basis for implementing the Vision at Rookwood detailed in the Plan of Management 2014. In 2010 the Rookwood Visual Significance Study was prepared by DEM, updating previous visual analysis from the 1993 Plan of Management and building on values beyond aesthetics. The results of the Visual Significance Study have identified the significant items of the heritage, built, natural and visual character in Rookwood. All of these are incorporated into one document.

The study informed the development of Management Units, defining areas of similar physical, cultural and visual values within this large, cultural landscape comprising Rookwood Necropolis. These Units provide smaller manageable precincts for actions to reflect the special characteristics embodied within each Unit, while undertaking the core activities of burial and cremation. A detailed description and assessment of the visual significance of each Management Unit is included in the Rookwood Visual Significance Study August 2010, DEM (Aust).

The Management Unit Policies for the twenty four Management Units defined within Rookwood Necropolis are presented here to complement the Plan of Management and provide key management priorities for each Unit. Whilst maintaining Rookwood's function as a Cemetery is paramount the key management priorities provide the core management function within each Management Unit. Strategic Directions are consistent with those in the Plan of Management. The numbering of the principles is consistent across all Management Units with only those principles that apply to the Management Unit included.

The Management Unit Policies are presented as:

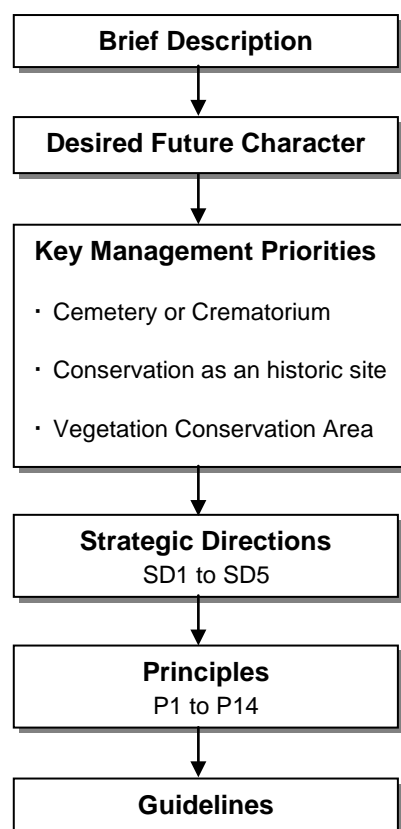

Management Unit 1 - Wesleyan No. 1

Description: One of the most intact areas within the State Heritage Register listed area- intimate in scale, circular parterres and gardens, vaults, trees- highly articulated with interpretation of historic layers possible. Design accredited to Charles Moore.

Desired Future Character:

Heritage landscape pattern- brick edges, gardens, trees, vaults- entire Victorian design maintained and interpreted. Visual connection with Mortuary Station reinforced.

KEY MANAGEMENT PRIORITIES:

- **Conservation as an historic site** – including interpretation

SD 1 Adopt sustainable management practices

P12 Identify opportunities for additional burial places, whilst maintaining Rookwood wide values- heritage, social, visual, vegetation and ecological.

12.1 The Unit is in SHR and is not generally suitable for intensification of use.

P14 Maintain all above ground structures for safety and retention of visual and heritage values:

SD 2 Protect Rookwood's heritage and conserve its environment

P 1 Maintain Visual Corridors:

- 1.1 Maintain the internal foreground views to the circular grassed/ gravel circulation paths.
- 1.2 Maintain visual connection with Unit 7.

P 2 Maintain Historic Circulation Routes including setting and material fabric:

- 2.1 Maintain curvilinear paths in scale, materials and landscape character.

P3 Maintain landscape pattern of areas within State Heritage Register (SHR):

- 3.1 Protect historic circulation routes in entire area.

P4 Maintain landscape design including influences of prominent individuals:



- 4.1 Maintain the pattern of intact fabric and highly articulated paths and planning of the Charles Moore Plan (one of the best examples of this style at Rookwood).

P5 Maintain heritage monuments, features, landmarks of artistic, creative and technical value including their settings:

- 5.1 Protect and maintain historic vaults including the landscape planting and setting.
- 5.2 Protect all heritage monuments identified in heritage study- maintain inventory.
- 5.3 Maintain the spatial qualities and landscape context/setting of all vaults and burial areas.
- 5.4 Protect character of the Lidcombe gates, walls, sculpture by Hossein Valamanesh and the landscape setting.

P6 Interpret significant heritage features and/or heritage items no longer present:

- 6.1 Strengthen the visual connection with Unit 7, original Mortuary station site.

P7 Implement and reinforce established street hierarchy- primary, secondary, tertiary.

- 7.1 Maintain Necropolis Drive, Necropolis Crt and Cohen Ave - primary roads- RNT to manage existing tree planting as part of a Tree management policy.

Management Unit 1 - Wesleyan No. 1

P8 Maintain significant trees/vegetation/ botanical items of rarity- refer Significant Tree Register and threatened species:

- 8.1 Maintain all trees and replace via an ongoing tree planting program- high priority are trees at high points near Unit 7.
- 8.2 Maintain all heritage roses.
- 8.3 Review Camphor Laurels within the Unit -damage to monuments. Take remedial action, in accordance with permissible heritage activities if required.
- 8.4 Protect all Threatened species- refer PMP.

P 10 Recognise high points and ridgelines: visually prominent areas:

- 10.1 Consult guidelines for ridgeline if undertaking activities in the high point - connection to Unit 7.

SD 4 Respect cultural diversity and equitable allocation of resources

P11 Maintain representative examples of social/religious group burial practices:

- 11.1 Retain and protect areas identified in the social mapping study.
- 11.2 Respect the autonomy and individuality of each faith in all activities.
- 11.3 Not suitable for renewable interment rights.

LEGEND



VISUAL CORRIDORS/
CONNECTIONS



INTERNAL VIEWS



FEATURES/MONUMENTS
LANDMARKS TO PROTECT



HISTORIC CIRCULATION
ROUTES



VEGETATION : INCLUDING
SIGNIFICANT VEG, LANDSCAPE
SETTING, VEGA. CONSERVATION
AREAS



RIDGELINE/VISUALLY
PROMINENT AREA



RENEWABLE TENURE OPTIONS
NOTE : NOT ALL POTENTIALLY
SUITABLE AREAS ARE SHOWN
REQUIRES FURTHER INVESTIGATION

15.1

NUMBERS REFER TO MANAGEMENT
GUIDELINES

This Legend applies to all of the
Management Unit Plans that follow

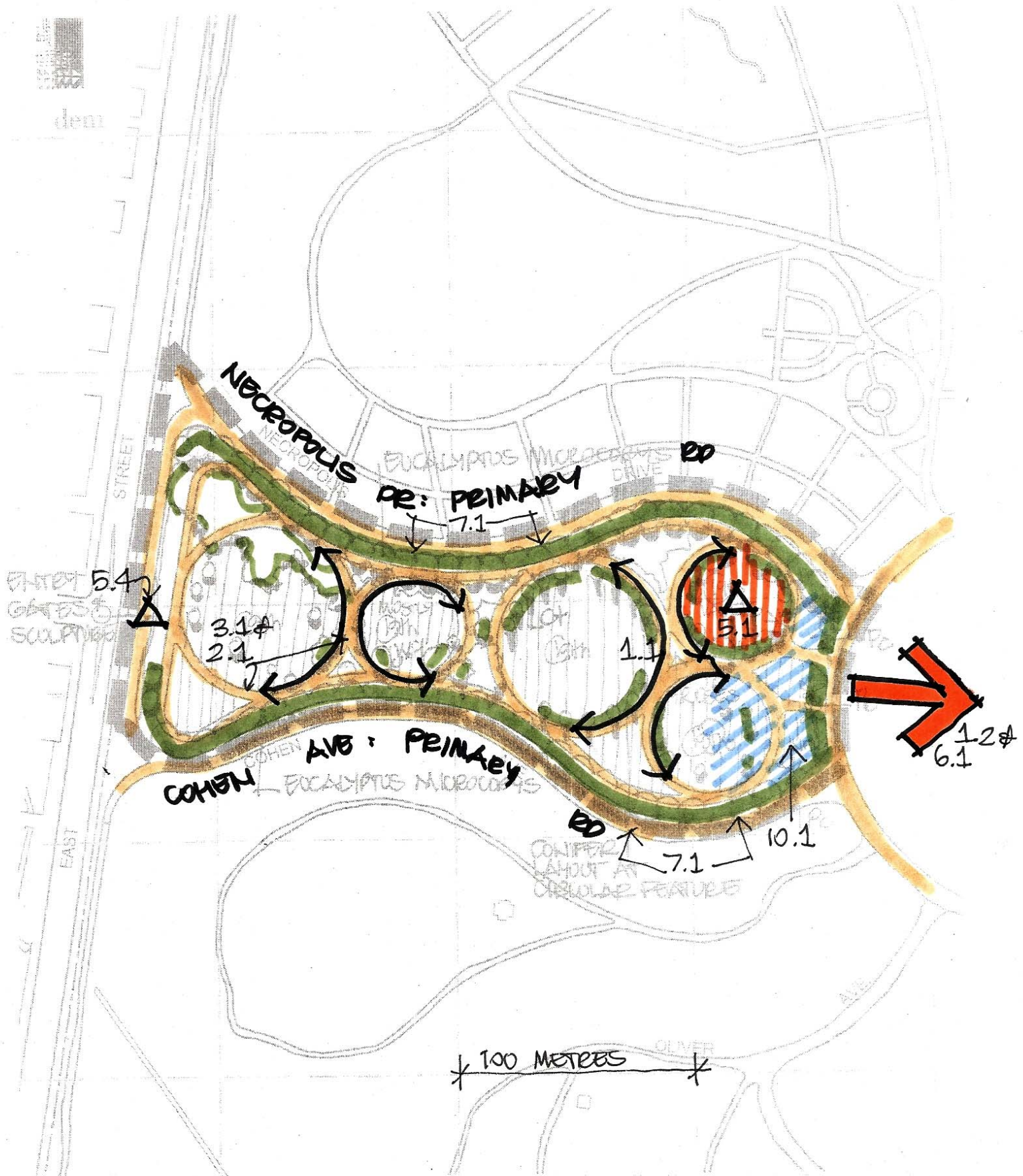

Unit 1

Rookwood Necropolis

Management Unit 2 - Catholic Area No 1

Description: State Heritage Register –Listed Area. First burial-1867. Alignment of railway spur is visible. Vaults reduce interpretation potential. Landmarks include St Michael the Archangel chapel, some Devonshire St monuments relocated here, Large Bunya, Hoop pines, trees and palms define circulation routes.

Desired Future Character:

Trees and circulation avenues defined and maintained, Serpentine protected, Railway spur interpreted, Views to Mortuary Station site reinforced.

KEY MANAGEMENT PRIORITIES:

- **Some Cemetery purposes-** additional burial in areas may be possible without compromising the heritage of the area.
- **Heritage conservation** and interpretation, Possible burial in areas to be identified whilst not compromising heritage conservation

SD 1 Adopt sustainable management practices

P12 Identify opportunities for additional burial places, whilst maintaining Rookwood wide values- heritage, social, visual, vegetation and ecological.

12.1 Areas where additional burial places could occur are in the central portion and along railway spur. (Refer Plan)

P14 Maintain all above ground structures for safety and retention of visual and heritage values:

SD 2 Protect Rookwood's heritage and conserve its environment

P 1 Maintain Visual Corridors:

- 1.1 Maintain/reinforce view south adjacent William Drive to Unit 7, by ensuring no structure or trees interrupts view. Avenue trees may be used to reinforce view.
- 1.2 Retain view from St Michael the Archangel north-west over Unit 2.



P 2 Maintain Historic Circulation Routes including setting and material fabric:

- 2.1 Maintain curvilinear Camphor Laurel avenue west of railway spur.
- 2.2 Maintain mature pines/trees defining circulation routes and progressively replace to retain character.
- 2.3 Maintain all heritage circulation routes remaining.
- 2.4 Reinforce the character of William Drive as the original railway reversing area, reinstate heritage trees and recognise its status as a secondary road.

P3 Maintain landscape pattern of areas within State Heritage Register (SHR):

- 3.1 Protect historic circulation routes around St Michael's Chapel and avenues/feature trees defining circulation routes.

P4 Maintain landscape design including influences of prominent individuals:

- 4.1 Refer above

P5 Maintain heritage monuments, features, landmarks of artistic, creative and technical value including their settings:

- 5.1 Retain religious headstones unique in Rookwood
- 5.2 Protect historic vaults north and west of St Michael's Chapel.
- 5.3 Protect all heritage monuments identified in heritage study.
- 5.4 Maintain the spatial qualities and landscape context of the setting of St Michael the Archangel Chapel.

Management Unit 2 - Catholic Area No 1

P6 Interpret significant heritage features and/or heritage items no longer present:

- 6.1 Strengthen the visual corridor along the railway spur - reinstate tree avenue and design special burial layout that interprets the corridor- ie longitudinal orientation of burials parallel to alignment is preferred.

P7 Implement and reinforce established street hierarchy- primary, secondary, tertiary.

- 7.1 Implement established road hierarchy for William Drive - secondary road - establish tree planting and road profile, along with replacement of heritage/landmark trees.
- 7.2 Maintain the existing characteristics of Necropolis Drive - primary road, on southern edge of Unit 2. Tree planting (*E. microcorys*) to be protected and replaced when required

P8 Maintain significant trees/vegetation/ botanical items of rarity- refer Significant Tree Register and threatened species:

- 8.1 Maintain and progressively replace all pines, camphor laurels and trees according to recommendations of significant vegetation study.
- 8.2 Maintain and reinforce boundary planting to Railway St and East St.

P9 Maintain historic serpentine and canal:

- 9.1 Protect and maintain serpentine including its setting.

P 10 Provide special consideration to High points and ridgelines: visually prominent areas:

- 10.1 Allow the ridgeline to be read in the context of the Unit by avoiding large structures along ridge, as these will conflict with the existing landmark of St Michael the Archangel.

SD 4 Respect cultural diversity and equitable allocation of resources

P11 Maintain representative examples of social/religious group burial practices-areas identified in social significance study:

- 11.1 Retain and protect areas identified in social mapping.

Management Unit 3 - Anglican Area No 1

Description: State Heritage Register- Listed area. First burial 1868. Monuments from Old Sydney Burial ground in George St, relocated here. Strong grid arrangement of circulation paths and trees. Design attributed to Simeon Pearce, and later JH Maiden- articulated, ornamental design. Serpentine Victorian gardens provided pleasure ground character to Cemetery- a major heritage asset. Large mature stone, hoop, bunya pines, cedars of Lebanon, palms. Botanic Garden style of planting recommended by JH Maiden. Includes Vegetation Conservation Area.

Desired Future Character:

Heritage landscape pattern- brick edges, circular gardens, fountains, statuary, monuments, vaults, maintained. Tree planting maintained and reinforced.

KEY MANAGEMENT PRIORITIES:

- **Conservation as an historic site.**
- **Vegetation Conservation Area** maintained in accordance with PMP.
- **Some Cemetery purposes-** in select areas

SD 1 Adopt sustainable management practices

P12 Identify opportunities for additional burial places, whilst maintaining Rookwood wide values- heritage, social, visual, vegetation and ecological.

12.1 Unit is within SHR area and is generally not suitable for renewable tenure. Few opportunities exist whilst maintaining SHR value.

P14 Maintain all above ground structures for safety and retention of visual and heritage values:

SD 2 Protect Rookwood's heritage and conserve its environment

P 1 Maintain Visual Corridors:

- 1.1 Maintain views east from William Drive along circulation paths.
- 1.2 Maintain views along Serpentine.



- 1.3 Maintain view along axis to Brick Polychrome Rest House from Necropolis Dr.

P 2 Maintain Historic Circulation Routes including setting and material fabric:

- 2.1 Maintain setting of Serpentine in scale and character. Level of maintenance may be concentrated in areas to reflect Victorian character, whilst other parts may be less intensive- dependent on resources.
- 2.2 Maintain the scale and character of the grid circulation system, including the circular features at the nodes of the grid. Maintain brick details.
- 2.3 Maintain connection with Unit 7, Mortuary Station site.

P3 Maintain landscape pattern of areas within State Heritage Register (SHR):

- 3.1 Protect historic circulation routes including the trees in the entire area.

P4 Maintain landscape design including influences of prominent individuals

- 4.1 Protect and maintain designs from Charles Moore, S.Pearce and JH Maiden areas, all represented in this Unit.

P5 Maintain heritage monuments, features, landmarks of artistic, creative and technical value including their settings:

- 5.1 Maintain feature monuments, urns, fountains, serpentine walls and structures (shade-rest houses- particularly restored examples)
- 5.2 Protect historic vaults.
- 5.3 Protect naval areas.

Management Unit 3 - Anglican Area No 1

P6 Interpret significant heritage features and/or heritage items no longer present:

- 6.1 Heritage items have been interpreted in this Unit. Investigate any further areas that could be interpreted. (Few additional items require interpretation)

P7 Implement and reinforce established street hierarchy- primary, secondary, tertiary.

- 7.1 Implement established road hierarchy for William Drive - secondary road - establish tree planting and road profile. Reflect historic circulation status of William Dr. as access to former Ranger's lodge.
- 7.2 Maintain the existing characteristics of Necropolis Drive - primary road, on southern edge of Unit 3. Tree planting (*P. canariensis*) to be protected and replaced when required. Implement management requirements of the palm arboricultural assessment to ensure long term future of tree avenue. Significant Tree Register and management strategy to be undertaken

P8 Maintain significant trees/vegetation/ botanical items of rarity- refer Significant Tree Register and threatened species:

- 8.1 Maintain and progressively replace all significant trees, in particular landmark trees according to results of significant tree register.
- 8.2 Maintain and reinforce boundary planting along Railway St.
- 8.3 Maintain Vegetation Conservation area in accordance with the TSC Act requirements and PMP.

P9 Maintain historic serpentine and canal:

- 9.1 Protect and maintain serpentine including its setting and high quality landscape design.

P 10 Provide special consideration to high points and ridgelines: visually prominent areas:

- 10.1 Allow the ridgeline on William Drive to be read in the context of the Unit by avoiding large structures along ridge, replace significant landmark trees (*Araucaria* sp.) and maintain/manage existing trees.
- 10.2 Replace and manage significant/landmark trees adjacent Necropolis Crt and connection to Unit 7

SD 4 Respect cultural diversity and equitable allocation of resources

P11 Maintain representative examples of social/religious group burial practices-areas identified in social significance study:

- 11.1 Retain and protect areas identified in social mapping.

Management Unit 4 - Anglican

Description: Monuments early to late 20th Century. Complimentary to Unit 3 with less detail and smaller nodal features, structures. Pines, palms, trees are visible landmarks. Structures on ridgeline at Hawthorn Ave- All Souls Chapel are also landmarks. Includes Vegetation Conservation Area.

Desired Future Character:

Western portion from Canal attributed to JH Maiden, to be maintained in its landscape pattern, trees and materials. Grid arrangement retained.

KEY MANAGEMENT PRIORITIES:

- **Cemetery purposes** - burial in areas to be identified, identification of opportunities to intensify use and/or introduce renewable interment rights.
- **Heritage conservation**- Some areas
- **Vegetation Conservation Area** maintained in accordance with PMP.

SD 1 Adopt sustainable management practices

P12 Identify opportunities for additional burial places, whilst maintaining Rookwood wide values- heritage, social, visual, vegetation and ecological.

- 12.1 Unit has potential for investigating additional burial places.
- 12.2 Explore 'natural burial' within the Vegetation Conservation Area in accordance with OEH approval.

P14 Maintain all above ground structures for safety and retention of visual and heritage values:

SD 2 Protect Rookwood's heritage and conserve its environment

P 1 Maintain Visual Corridors:

- 1.1 Maintain long panoramic views east from Haslem Drive along circulation paths to ridge at Hawthorne Ave.
- 1.2 Maintain views from ridge at Hawthorne Ave west along axis of circulation paths.



P 2 Maintain Historic Circulation Routes including setting and material fabric:

- 2.1 Maintain the scale and character of the grid circulation system, including the circular features at the nodes of the grid.

P3 Maintain landscape pattern of areas within State Heritage Register (SHR):

- 3.1 Not applicable

P4 Maintain representation of cemetery and landscape design including influences of significant people:

- 4.1 Protect and maintain area west of the canal designed by JH Maiden.

P5 Maintain heritage monuments, features, landmarks of artistic, creative and technical value including their settings:

- 5.1 Maintain monuments identified in heritage studies.

P6 Interpret significant heritage features and/or heritage items no longer present:

- 6.1 Some rest Houses are currently being restored - Investigate further restoration potential.

P7 Implement and reinforce established street hierarchy- primary, secondary, tertiary.

- 7.1 Implement established road hierarchy for Haslem Drive, and Hawthorne Ave - secondary roads- establish tree planting and road profile.

Management Unit 4 - Anglican

- 7.2 Maintain the existing characteristics of Necropolis Drive - primary road, on southern edge of Unit 4. Tree planting (*P. canariensis* and *L.confertus*) to be protected and replaced when required. The current monitoring of the health of the palms and longevity to be continued to ensure long term future tree avenue. Tree management strategy to be carried out.

P8 Maintain significant trees/vegetation/ botanical items of rarity- refer Significant Tree Register and threatened species:

- 8.1 Maintain and progressively replace all significant trees according to results of significant tree study.
- 8.2 Maintain and reinforce boundary planting along Graham Ave.
- 8.3 Maintain Vegetation Conservation area in accordance with the established PMP.

P9 Maintain historic serpentine and canal:

- 9.1 Protect and maintain canal according to recommendations of the canal study.

P 10 Provide special consideration to High points and ridgelines: visually prominent areas:

- 10.1 Consider the design outcome to the visual context of Rookwood as a whole in relation to any development on the ridgeline on Hawthorne Ave. Consult guidelines for ridgelines. (to be prepared)

SD 4 Respect cultural diversity and equitable allocation of resources

P11 Maintain representative examples of social/religious group burial practices-areas identified in social significance study:

- 11.1 Retain and protect areas identified in social mapping.

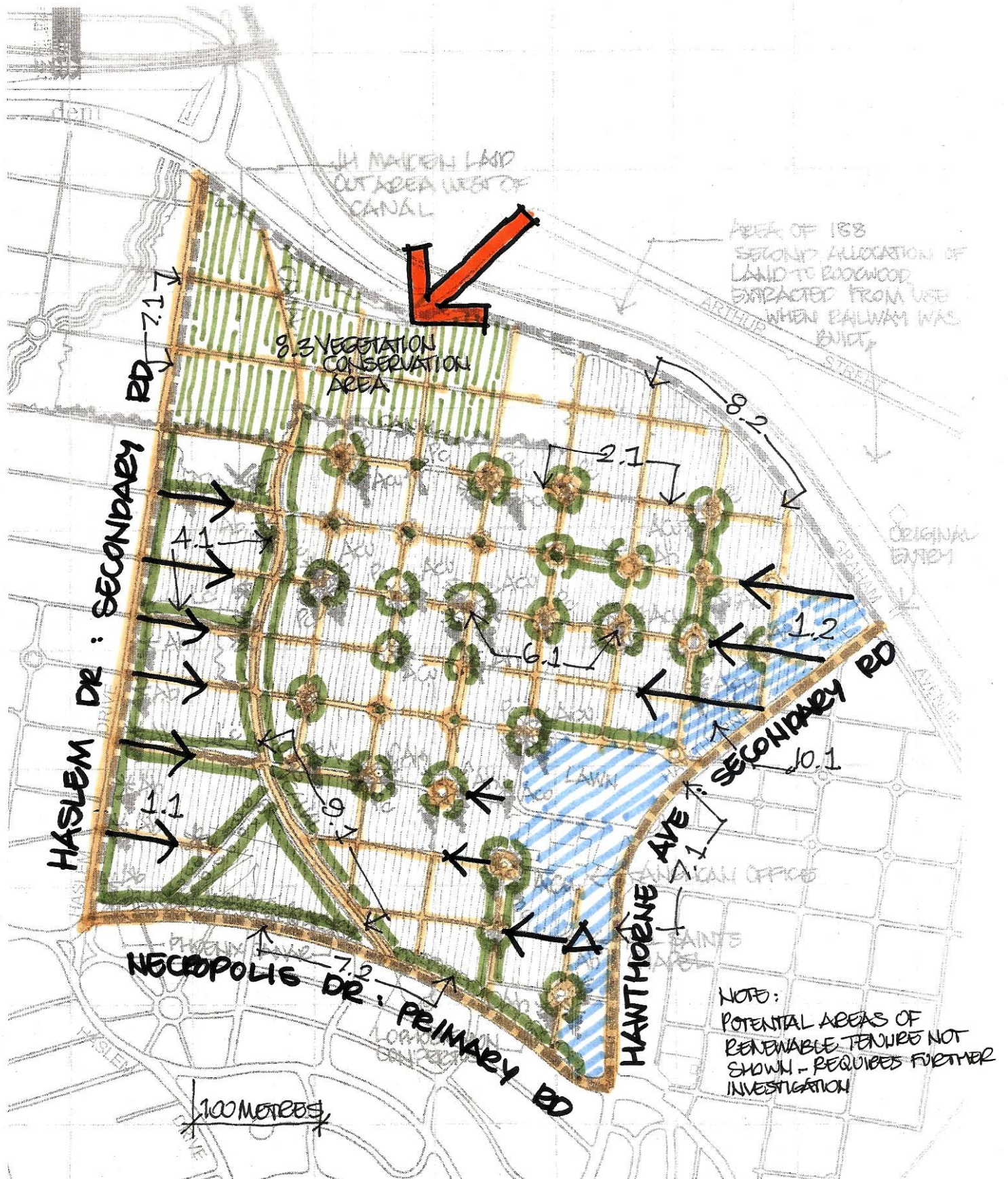

Unit 4

Rookwood Necropolis

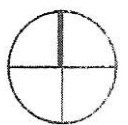

Management Unit 5 - Anglican

Description: Post 1940-70's burial in modified grid- simpler pattern to Edwardian burials of earlier Anglican areas. Bunya & Hoop pines, Date/Canary Is palms punctuate the grid. Part is located on Hawthorne Ave ridge with panoramic views to CBD.

Desired Future Character:

Views to east retained to CBD, Axial pattern of circulation routes defined by palm/pine/tree planting retained and reinforced. Alignment of Railway interpreted.

KEY MANAGEMENT PRIORITIES:

- **Cemetery purposes** - burial in areas to be identified, identification of opportunities to intensify use and/or introduce renewable interment rights.

SD 1 Adopt sustainable management practices

P12 Identify opportunities for additional burial places, whilst maintaining Rookwood wide values- heritage, social, visual, vegetation and ecological.

- 12.1 Exclude the high value heritage and significant social / religious burial areas.
- 12.2 Any additional burial opportunities are to follow the grid layout-current circulation patterns– Investigate if any circulation routes could be closed and used for burial.
- 12.3 Avoid isolated infill to reduce conflicts if entire areas of renewable **interment rights** are proposed.
- 12.4 Explore 'natural burial' within the regenerated woodland at the eastern edge of the Unit.

P14 Maintain all above ground structures for safety and retention of visual and heritage values:

SD 2 Protect Rookwood's heritage and conserve its environment

P 1 Maintain Visual Corridors:

- 1.1 Maintain views east from Hawthorne Ave to the CBD skyline.
- 1.2 Maintain views to CBD skyline east from Merchant Navy area.
- 1.3 Maintain views along axis circulation paths as representative of grid cemetery plan.



P 2 Maintain Historic Circulation Routes including setting and material fabric:

- 2.1 Maintain grid circulation paths, including defining trees as continuation of the principles of Pearce and Maiden.

P6 Interpret significant heritage features and/or heritage items no longer present:

- 6.1 Interpret the site of the railway reversing area on ridge adjacent Necropolis Dr- in accordance with heritage guidelines.

P7 Implement and reinforce established street hierarchy- primary, secondary, tertiary:

- 7.1 Maintain the existing characteristics of Necropolis Drive (Primary Road) on the southern edge of Unit 5- Trees (*E. microcorys*) to be protected and replaced when required to maintain avenue- RNT.
- 7.2 Establish tree planting and profiles of the Secondary Road- Hawthorne Avenue.

P8 Maintain significant trees/vegetation/ botanical items of rarity- refer Significant Tree Register and threatened species:

- 8.1 Maintain Bunya and Hoop pines, Date and Canary Is palms- continue management & replacement program.
- 8.2 Maintain and reinforce boundary planting along Graham Ave and railway embankment.
- 8.3 Protect all Threatened species- refer PMP.

Management Unit 5 - Anglican

P9 Maintain historic serpentine and canal:

- 9.1 Maintain drainage functions of gully on the eastern boundary of the Unit.

P 10 Recognise high points and ridgelines- visually prominent areas:

- 10.1 Protect the ridgeline on Hawthorne Ave- special consideration in design of any structures. Adhere to architectural guidelines.

SD 4 Respect cultural diversity and equitable allocation of resources

P11 Maintain representative examples of social/religious group burial practices:

- 11.1 Retain and protect areas identified in social mapping.

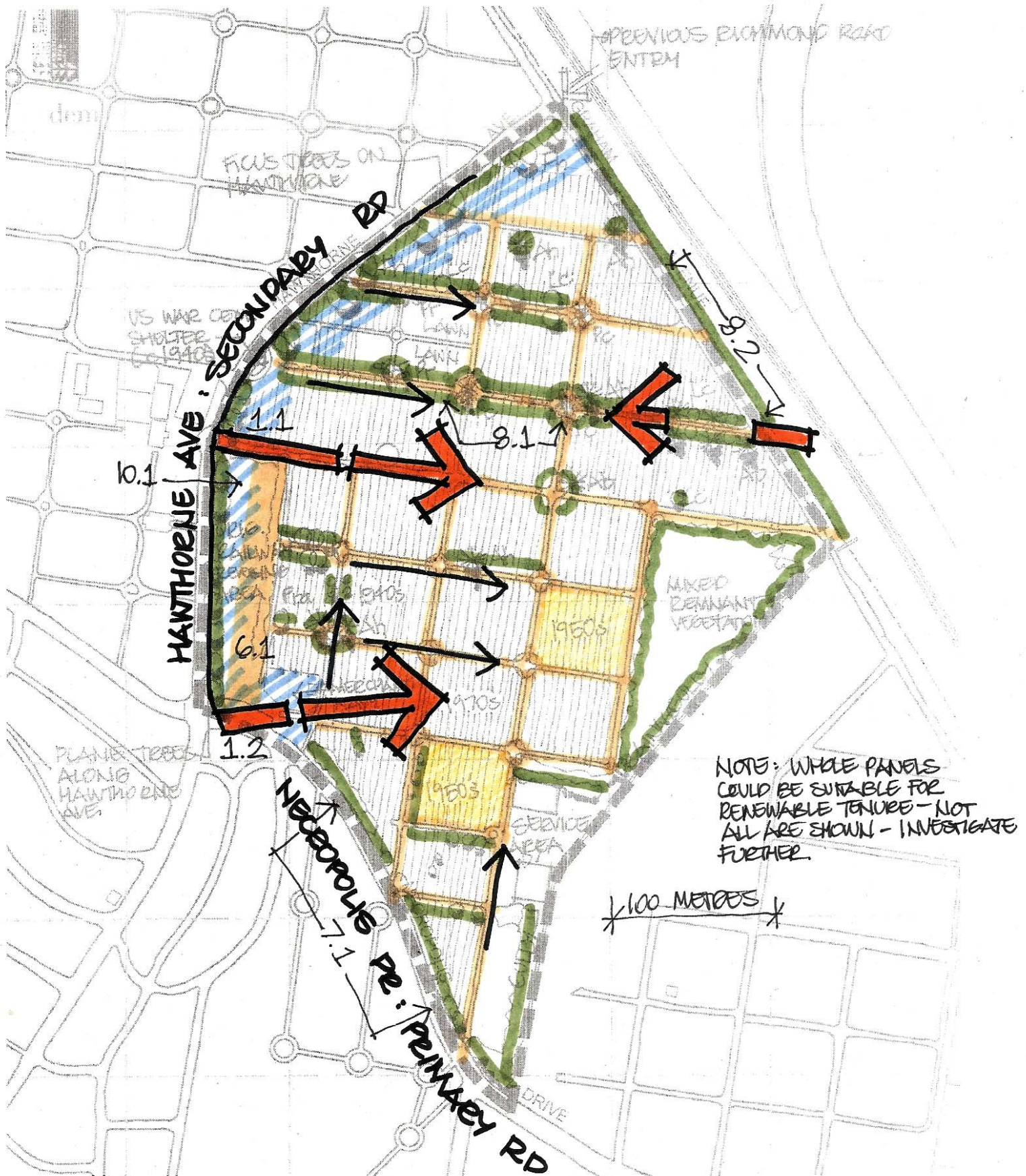

Unit 5

Rookwood Necropolis



Management Unit 6 - Anglican, Russian/Serbian Orthodox

Description: 1940 to post 1950's burial, in grid layout. Russian Orthodox shrine is a focal point.

Desired Future Character:

Areas retained to represent social/religious burial of Russian, Serbian Orthodox faith.

KEY MANAGEMENT PRIORITIES:

- **Cemetery purposes** - burial in areas to be identified, identification of opportunities to intensify use and/or introduce renewable interment rights.

SD 1 Adopt sustainable management practices

P12 Identify opportunities for additional burial places, whilst maintaining Rookwood wide values- heritage, social, visual, vegetation and ecological.

- 12.1 Utilisation of the Unit for intensification of use could occur, excluding the areas identified as representative of social religious burial practices. (identified in Social mapping study)
- 12.2 Areas to be investigated for intensification of use should follow the grid layout of the current circulation patterns - maintaining every second circulation road, burying in others.
- 12.3 Avoid isolated infill to reduce conflicts if entire areas of renewable tenure are proposed.
- 12.4 Explore 'natural burial' whilst maintaining the *Themeda* grassland in current pauper burial area.

P14 Maintain all above ground structures for safety and retention of visual and heritage values:

SD 2 Protect Rookwood's heritage and conserve its environment

P 1 Maintain Visual Corridors:

- 1.1 No important visual corridors exist in this Unit.

P5 Maintain heritage monuments, features, landmarks of artistic, creative and technical value including their settings:

- 5.1 Maintain the Russian Orthodox Shrine as a social/visual landmark within the Unit.



P7 Implement and reinforce established street hierarchy- primary, secondary, tertiary.

- 7.1 Maintain the existing characteristics of Necropolis Drive on the southern edge of Unit 6- Trees (*E. microcorys*) to be protected and replaced when required to maintain avenue.

P8 Maintain significant trees/vegetation/ botanical items of rarity- refer Significant Tree Register and threatened species:

- 8.1 Maintain the *Themeda* grassland used for pauper burials as flora and fauna habitat.
- 8.2 Maintain and reinforce boundary planting along Graham Ave, railway embankment and Council depot.

P9 Maintain historic serpentine and canal:

- 9.1 No historic serpentine or canal exists. Maintain drainage functions of drainage gully on the northern boundary of the Unit.

SD 4 Respect cultural diversity and equitable allocation of resources

P11 Maintain representative examples of social/religious group burial practices-areas identified in social significance study:

- 11.1 Retain and protect areas identified in social mapping.

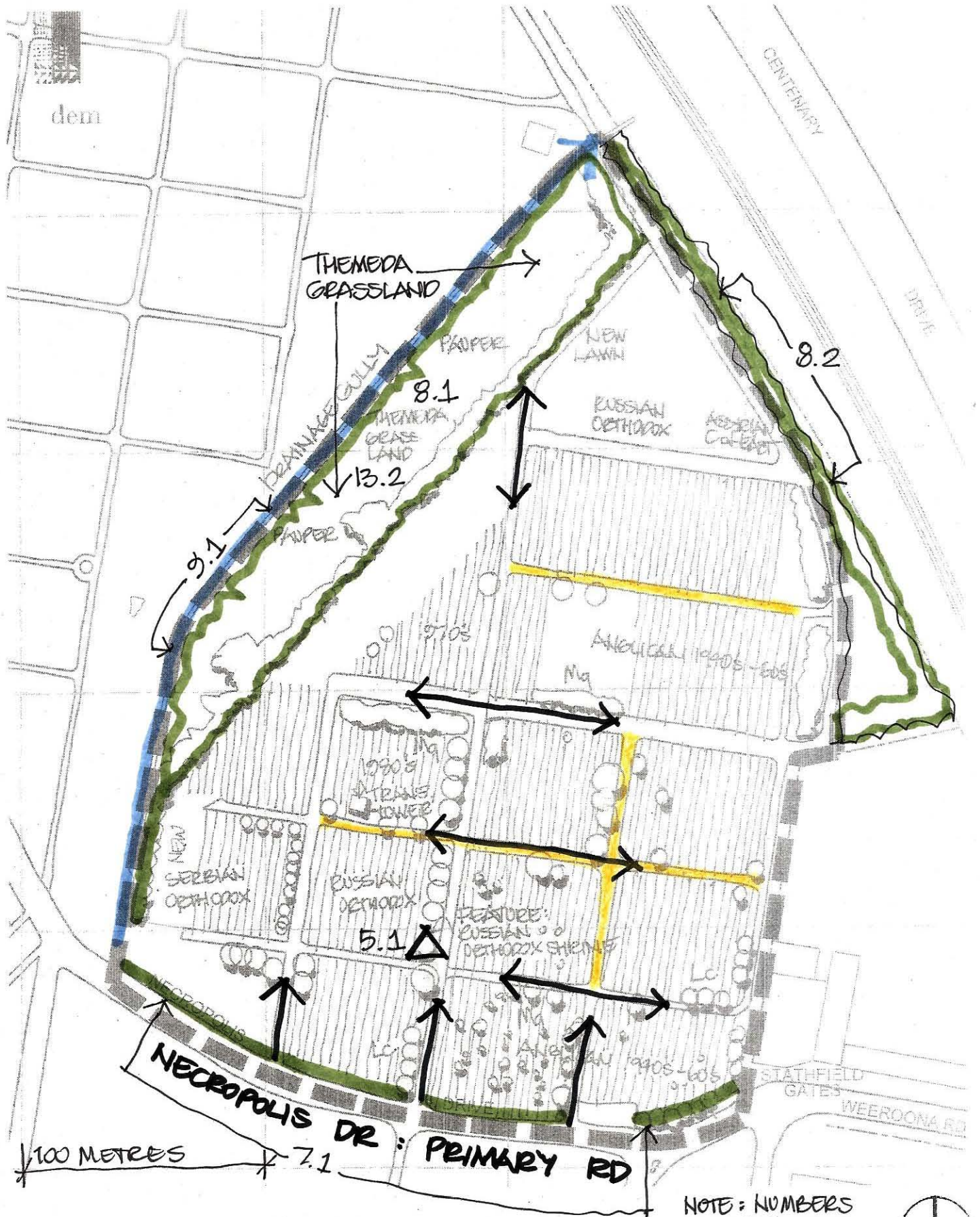

Unit 6 Rookwood Necropolis

Management Unit 7 - Mortuary Station No 1 site

Description: State Heritage Register- Listed area. Central focus of Victorian Cemetery layout attributed to Charles Moore. Mortuary Station No. 1 completed in 1869-James Barnet Architect. Area includes lawn burial, columbarium, Jewish Martyrs Memorial. Prominent high point located on spur ridge, views afforded to and beyond the site.

Desired Future Character:

Heritage significance of this focal point respected in complimentary burial treatment. Current disjointed layout integrated better to reflect heritage significance.

KEY MANAGEMENT PRIORITIES:

- **Conservation as an historic site.**
- **Some Cemetery purposes-** additional burial in areas may be possible without compromising the heritage of the area.

SD 1 Adopt sustainable management practices

P12 Identify opportunities for additional burial places, whilst maintaining Rookwood wide values- heritage, social, visual, vegetation and ecological.

- 12.1 Unit is within SHR area with opportunities for improvement, designed to complement the Unit's heritage significance.
- 12.2 Avoid isolated infill to reduce conflicts if entire areas of renewable tenure are proposed.
- 12.3 Respect faiths that do not support renewable tenure and comply with religious requirements.
- 12.4 Sustainable use to comply with conservation of heritage fabric.

P14 Maintain all above ground structures for safety and retention of visual and heritage values:

SD 2 Protect Rookwood's heritage and conserve its environment

P 1 Maintain Visual Corridors:

- 1.1 Maintain long views north and south along the previous railway alignment.
- 1.2 Maintain views into the Unit from each of the No. 1 areas surrounding.



P 2 Maintain Historic Circulation Routes including setting and material fabric:

- 2.1 Maintain setting of Mortuary Station No.1 and reinforce connections with surrounding units.

P3 Maintain landscape pattern of areas within State Heritage Register (SHR):

- 3.1 Protect historic circulation routes and connections with No.1 areas.

P4 Maintain landscape design including influences of prominent individuals:

- 4.1 Protect and maintain design by Charles Moore, with no compromise of the circular form of this unit.

P5 Maintain heritage monuments, features, landmarks of artistic, creative and technical value including their settings:

- 5.1 Maintain heritage structures including Mortuary Station, Station master's store.
- 5.2 Maintain Jewish Martyrs Memorial and consider context of external walls /setting- include conservation issues with Jewish Board of Deputies, Heritage Council and National Trust.

Management Unit 7 - Mortuary Station No 1 site

P6 Interpret significant heritage features and/or heritage items no longer present:

- 6.1 Heritage items have been interpreted in this Unit. Consider additional interpretation of Mortuary Station to further represent railway context at Rookwood.

P7 Implement and reinforce established street hierarchy- primary, secondary, tertiary.

- 7.1 Maintain established road hierarchy for Necropolis Circuit - primary road – maintain tree planting (*P. canariensis*) and road profile. Implement management requirements of the palm study to ensure long term future of tree avenue. Tree management strategy to be undertaken.

P8 Maintain significant trees/vegetation/ botanical items of rarity- refer Significant Tree Register and threatened species:

- 8.1 Maintain and progressively replace all significant trees according to results of significant tree study and management strategy.
- 8.2 Undertake accurate and respectful implementation of religious requirements in tree planting and management actions.
- 8.3 Tree management needs to take account of the Jewish law Halacha that determines where trees are to be planted and maintained.

P 10 Provide special consideration to High points and ridgelines: visually prominent areas:

- 10.1 Allow the high point of this Unit to be read in the context of the Cemetery by retaining existing Mortuary interpretive structure on ridge and maintaining trees. Consult guidelines for ridgelines (to be prepared).

SD 4 Respect cultural diversity and equitable allocation of resources

P11 Maintain representative examples of social/religious group burial practices-areas identified in social significance study:

- 11.1 Retain and protect areas identified in social mapping.
- 11.2 Respect the autonomy and individuality of each faith in all activities.

Management Unit 8 - Presbyterian No. 1

Description: State Heritage Register- Listed area. Intact layout of circular and intricate burial pattern, vaults and heritage monuments. Frazer vault provides impressive focal point.

Desired Future Character:

Original landscape pattern of circular brick kerbs, gutters, cross patterns and tree planting retained.

KEY MANAGEMENT PRIORITIES:

- **Conservation as an historic site.**
- **Some Cemetery purposes-** additional burial in areas may be possible without compromising the heritage of the area.

SD 1 Adopt sustainable management practices

P12 Identify opportunities for additional burial places, whilst maintaining Rookwood wide values- heritage, social, visual, vegetation and ecological.

- 12.1 The Unit is in SHR and careful design considerations are required for Intensification of use.
- 12.2 Few areas are suitable for further development in this Unit, however areas in the western portion could be investigated for better use of cemetery space.

P14 Maintain all above ground structures for safety and retention of visual and heritage values:

SD 2 Protect Rookwood's heritage and conserve its environment

P 1 Maintain Visual Corridors:

- 1.1 Maintain the foreground internal views along the grassed circulation paths.
- 1.2 Maintain visual connection with Unit 7.

P 2 Maintain Historic Circulation Routes including setting and material fabric:

- 2.1 Maintain curvilinear paths in scale, materials and landscape character.



P3 Maintain landscape pattern of areas within State Heritage Register (SHR):

- 3.1 Protect historic circulation routes in entire area.

P4 Maintain landscape design including influences of prominent individuals:

- 4.1 Maintain the pattern of intact fabric and highly articulated paths and planning of the Charles Moore Plan .

P5 Maintain heritage monuments, features, landmarks of artistic, creative and technical value including their settings:

- 5.1 Protect and maintain historic vaults including the landscape planting and setting.
- 5.2 Protect all heritage monuments identified in heritage study- maintain inventory.
- 5.3 Maintain the spatial qualities and landscape context/setting of all vaults and burial areas including fencing and details of enclosures.

P6 Interpret significant heritage features and/or heritage items no longer present:

- 6.1 Strengthen the visual connection with Unit 7, original Mortuary station site.

P7 Implement and reinforce established street hierarchy- primary, secondary, tertiary.

- 7.1 Maintain Necropolis Drive, Necropolis Crt and Cohen Ave - primary roads- RNT to manage existing tree planting as part of a Tree management policy

Management Unit 8 - Presbyterian No. 1

P8 Maintain significant trees/vegetation/ botanical items of rarity- refer Significant Tree Register:

- 8.1 Maintain all trees according to results of Significant Tree study, particularly trees in area near Necropolis Circuit.

P9 Maintain historic serpentine and canal:

- 9.1 Maintain canal in wet area, review drainage in lower area.

P 10 Recognise high points and ridgelines: visually prominent areas:

- 10.1 Consult guidelines for ridgeline if undertaking activities in the high point - connection to Unit 7.

11 SD 4 Respect cultural diversity and equitable allocation of resources

P11 Maintain representative examples of social/religious group burial practices:

- 11.1 Retain and protect areas identified in the social mapping study.

Management Unit 8A - General No. 1

Description: Not listed in the SHR, although a No. 1 area. Chinese pavilion- 1877 provides Chinese cultural focal point. Area is sparsely marked with sandstone stelae and open in character.

Desired Future Character:

Alignment of the Railway spur identified and interpreted, Quong Sin Tong monument protected.

KEY MANAGEMENT PRIORITIES:

- **Conservation as an historic site.**
- **Some Cemetery purposes-** additional burial in areas may be possible without compromising the heritage of the area.

SD 1 Adopt sustainable management practices

P12 Identify opportunities for additional burial places, whilst maintaining Rookwood wide values- heritage, social, visual, vegetation and ecological.

12.1 The Unit may provide opportunities for further development- investigate potential.

12.2 Sustainable use to comply with conservation of heritage fabric.

P14 Maintain all above ground structures for safety and retention of visual and heritage values:

SD 2 Protect Rookwood's heritage and conserve its environment

P 1 Maintain Visual Corridors:

- 1.1 Maintain views to the Chinese pavilion from Necropolis Circuit. Enclose views elsewhere.
- 1.2 Maintain visual connection with Unit 7.

P 2 Maintain Historic Circulation Routes including setting and material fabric:

- 2.1 Maintain curvilinear paths to Chinese pavilion as more defined circulation routes.

P3 Maintain landscape pattern of areas within State Heritage Register (SHR):

- 3.1 Protect historic circulation routes described in 2.1.



P4 Maintain landscape design including influences of prominent individuals:

- 4.1 Maintain the circular pattern of the surrounding roads and internal circulation routes.

P5 Maintain heritage monuments, features, landmarks of artistic, creative and technical value including their settings:

- 5.1 Protect and maintain Chinese pavilion and surrounding fabric.
- 5.2 Protect all heritage monuments identified in heritage study and monuments of families.

P6 Interpret significant heritage features and/or heritage items no longer present:

- 6.1 Interpret the railway corridor and connection with Unit 7.

P7 Implement and reinforce established street hierarchy- primary, secondary, tertiary.

- 7.1 Maintain the established road hierarchy for Necropolis Circuit, Farrer Ave- primary roads, and Barnet Ave- secondary road. Implement and manage tree planting avenues as part of road hierarchy.

P8 Maintain significant trees/vegetation/ botanical items of rarity- refer Significant Tree Register:

Management Unit 8A - General No. 1

- 8.1 Some native orchids are present in the area and should be protected.
- 8.2 Undertake accurate and respectful implementation of religious requirements in tree planting and management actions.

P 10 Recognise high points and ridgelines: visually prominent areas:

- 10.1 Visual high point connection with Unit 7 requires reinforcement.

11 SD 4 Respect cultural diversity and equitable allocation of resources

P11 Maintain representative examples of social/religious group burial practices:

- 11.1 Retain and protect Chinese burial areas and monuments in accordance with the social mapping study.
- 11.2 Respect the autonomy and individuality of each faith in all activities.

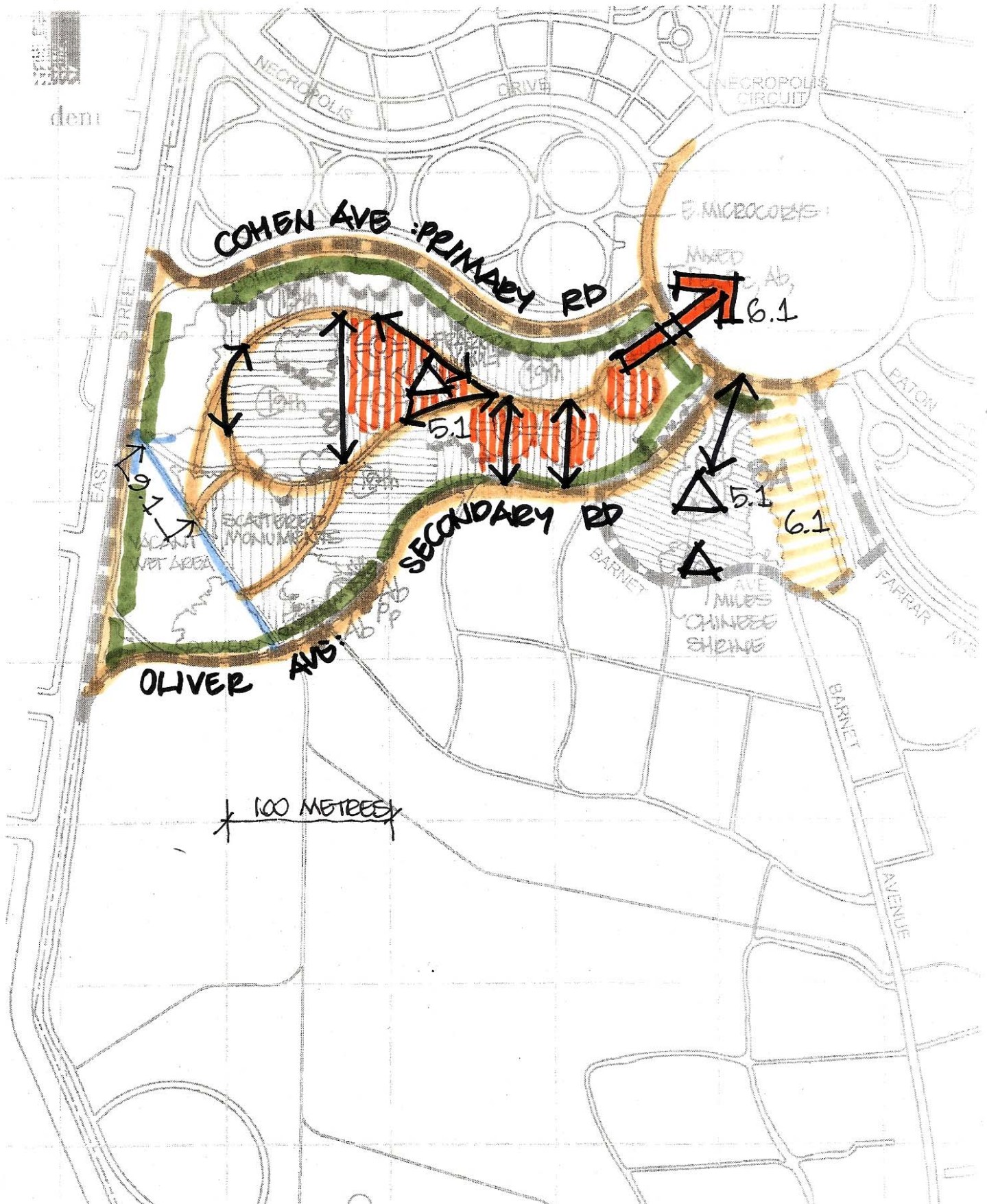

Units 8 & 8A Rookwood Necropolis

Management Unit 9 - Catholic

Description: Late 19th to 20th century burials in grid layout defined by tree lined streets. Brushbox, Canary Is palms and pines define areas with serpentine/canal draining the western slope. Vaults, stelae, slab and desk monuments.

Desired Future Character:

Palm/ tree planting, significant vegetation retained and reinforced. Brushbox avenue on Gilroy Ave, Canary Is palms on Freeman St protected and progressively reinstated where necessary. Canals protected and defined, axial views along circulation paths retained defining burial areas.

KEY MANAGEMENT PRIORITIES:

- **Cemetery purposes** - burial in areas to be identified, identification of opportunities to intensify use and/or introduce renewable interment rights.
- **Heritage Conservation**

SD 1 Adopt sustainable management practices

P12 Identify opportunities for additional burial places, whilst maintaining Rookwood wide values- heritage, social, visual, vegetation and ecological.

- 12.1 Areas suitable for additional burial may be available in the lawn burial and Early 20th Century burial areas, area north of canal- investigate further.

P14 Maintain all above ground structures for safety and retention of visual and heritage values:

SD 2 Protect Rookwood's heritage and conserve its environment

P 1 Maintain Visual Corridors:

- 1.1 Maintain the view corridors along the north-south and east- west circulation routes.
- 1.2 Maintain panoramic view from Barnet Ave north-west over the Unit and along the railway alignment. (Edge of Unit 9 and 13)
- 1.3 Maintain view from circular portion of Barnet Ave (high vantage point) to all areas beyond.



P 2 Maintain Historic Circulation Routes including setting and material fabric:

- 2.1 Maintain the grid of circulation routes particularly the avenue of trees defining these routes.

P5 Maintain heritage monuments, features, landmarks of artistic, creative and technical value including their settings:

- 5.1 Protect identified heritage monuments (in accordance with heritage study)

P6 Interpret significant heritage features and/or heritage items no longer present:

- 6.1 Strengthen the visual corridor of the Railway alignment on the eastern boundary of the Unit and within Unit 13. Define Trust boundary with Unit 13.

P7 Implement and reinforce established street hierarchy- primary, secondary, tertiary.

- 7.1 Maintain Barnet Ave and Haslem Drive - secondary road and other tertiary roads within the Unit, including trees.
- 7.2 Maintain vegetated buffer zones between contrasting burial types and social groups.

Management Unit 9 - Catholic

P8 Maintain significant trees/vegetation/ botanical items of rarity- refer Significant Tree Register and threatened species:

- 8.1 Maintain tree avenues along Gilroy Ave, Freeman Ave and *Phoenix* Palm avenue along southern canal- Replace when required as part of tree management strategy.
- 8.2 Maintain large *Araucarias*, *Eucalyptus* and other significant trees according to results of Significant tree study.
- 8.3 Reinforce and maintain boundary planting along East St- RNT.
- 8.4 Protect all Threatened species- refer PMP.

P9 Maintain historic serpentine and canal:

- 9.1 Maintain canals in accordance with canal study.

P 10 Provide special consideration to High points and ridgelines: visually prominent areas:

- 10.1 Consider planning on ridgeline along Barnet Ave and adjacent Unit 17 high point to ensure visually prominent area and views are not disrupted.

SD 4 Respect cultural diversity and equitable allocation of resources

P11 Maintain representative examples of social/religious group burial practices-areas identified in social significance study:

- 11.1 Retain and protect areas identified in social mapping.

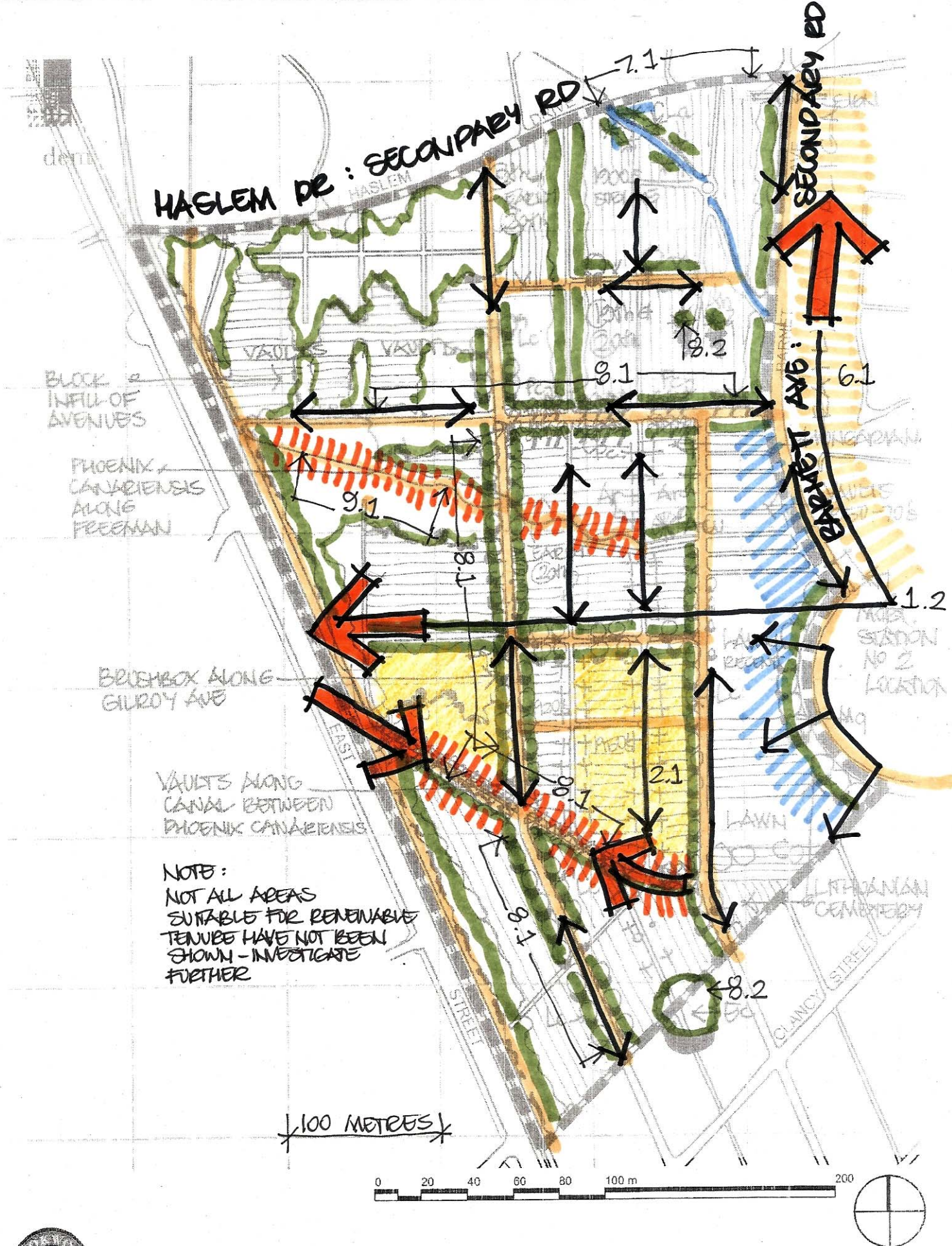

Unit 9

Rookwood Necropolis

Management Unit 10 - Independent

Description: Late 19th- early 20th Century burials. Parts included elaborate circular patterned layout with vaults as central focal points. Modified grid layout to remainder.

Desired Future Character:

Protection and conservation of original landscape pattern of one segment in grid- including kerbs, gutters, cross patterns, tree planting and vaults

KEY MANAGEMENT PRIORITIES:

- **Cemetery purposes** - burial in areas to be identified, identification of opportunities to intensify use and/or introduce renewable interment rights.
- **Heritage Conservation** to segment of grid including John Paul Vault and John Dunmore Lang vault.

SD 1 Adopt sustainable management practices

P12 Identify opportunities for additional burial places, whilst maintaining Rookwood wide values- heritage, social, visual, vegetation and ecological.

12.1 The Unit may be suitable for additional burial in areas of early 20th Century slab and desk monuments- investigate further.

P14 Maintain all above ground structures for safety and retention of visual and heritage values:

SD 2 Protect Rookwood's heritage and conserve its environment

P 1 Maintain Visual Corridors:

1.1 Maintain the middleground internal views along the north-south circulation paths.

P 2 Maintain Historic Circulation Routes including setting and material fabric:

2.1 Maintain the curvilinear paths in scale, materials and landscape character.

P3 Maintain landscape pattern of areas within State Heritage Register (SHR):

3.1 Protect landscape pattern in the vault area.



P4 Maintain landscape design including influences of prominent individuals:

4.1 Maintain the pattern of intact fabric and highly articulated paths and planning of the vault area.

P5 Maintain heritage monuments, features, landmarks of artistic, creative and technical value including their settings:

5.1 Protect and maintain the historic vaults in Unit including the landscape planting and setting.

P7 Implement and reinforce established street hierarchy- primary, secondary, tertiary.

7.1 Maintain the established road hierarchy for Oliver Ave and Barnet Ave- secondary roads- establish road profile, plant and manage trees as part of a Tree management policy.

P8 Maintain significant trees/vegetation/ botanical items of rarity- refer Significant Tree Register:

8.1 Maintain pines along Oliver Avenue and instigate replacement planting program.

P9 Maintain historic serpentine and canal:

9.1 Maintain canal in south and west according to canal study.

SD 4 Respect cultural diversity and equitable allocation of resources

P11 Maintain representative examples of social/religious group burial practices-areas identified in social significance study:

Management Unit 10 - Independent

11.1 Retain and protect vaults of political figures and persons of identity in accordance with social mapping.



dem



Unit 10

Rookwood Necropolis

Management Unit 11 – Independent and Catholic

Description: Majority of area- 20th Century burials. Low areas and poorly drained around canals, large area allocated to Vegetation Conservation in two portions.

Desired Future Character:

Protection of Vegetation Conservation Areas.
Sensitive burial and renewal in other areas- not fully utilised at present.

KEY MANAGEMENT PRIORITIES:

- **Cemetery purposes** - burial in areas to be identified, identification of opportunities to intensify use and/or introduce renewable interment rights.
- **Vegetation Conservation Area** maintained in accordance with PMP.

SD 1 Adopt sustainable management practices

P12 Identify opportunities for additional burial places, whilst maintaining Rookwood wide values- heritage, social, visual, vegetation and ecological.

- 12.1 The Unit may be suitable for renewable tenure.
- 12.2 The Unit is not fully buried and is being developed for burial in areas. Consider juxtaposition of burial styles when designing burial layouts and planting schemes.

P14 Maintain all above ground structures for safety and retention of visual and heritage values:

SD 2 Protect Rookwood's heritage and conserve its environment

P 1 Maintain Visual Corridors:

- 1.1 Maintain the internal visual buffer provided by the Vegetation Conservation Areas.

P7 Implement and reinforce established street hierarchy- primary, secondary, tertiary.

- 7.1 Maintain Vegetation Conservation Areas as part of TSC Act requirements and PMP.



P8 Maintain significant trees/vegetation/ botanical items of rarity- refer Significant Tree Register:

- 8.1 Maintain all trees according to results of Significant vegetation study.
- 8.2 Reinforce and maintain boundary screen planting along East St- particularly near Tenison Woods Dr for visual enclosure.

P9 Maintain historic serpentine and canal:

- 9.1 Maintain canals according to canal study.

SD 4 Respect cultural diversity and equitable allocation of resources

P11 Maintain representative examples of social/religious group burial practices:

- 11.1 Retain and protect areas identified in the social mapping study.

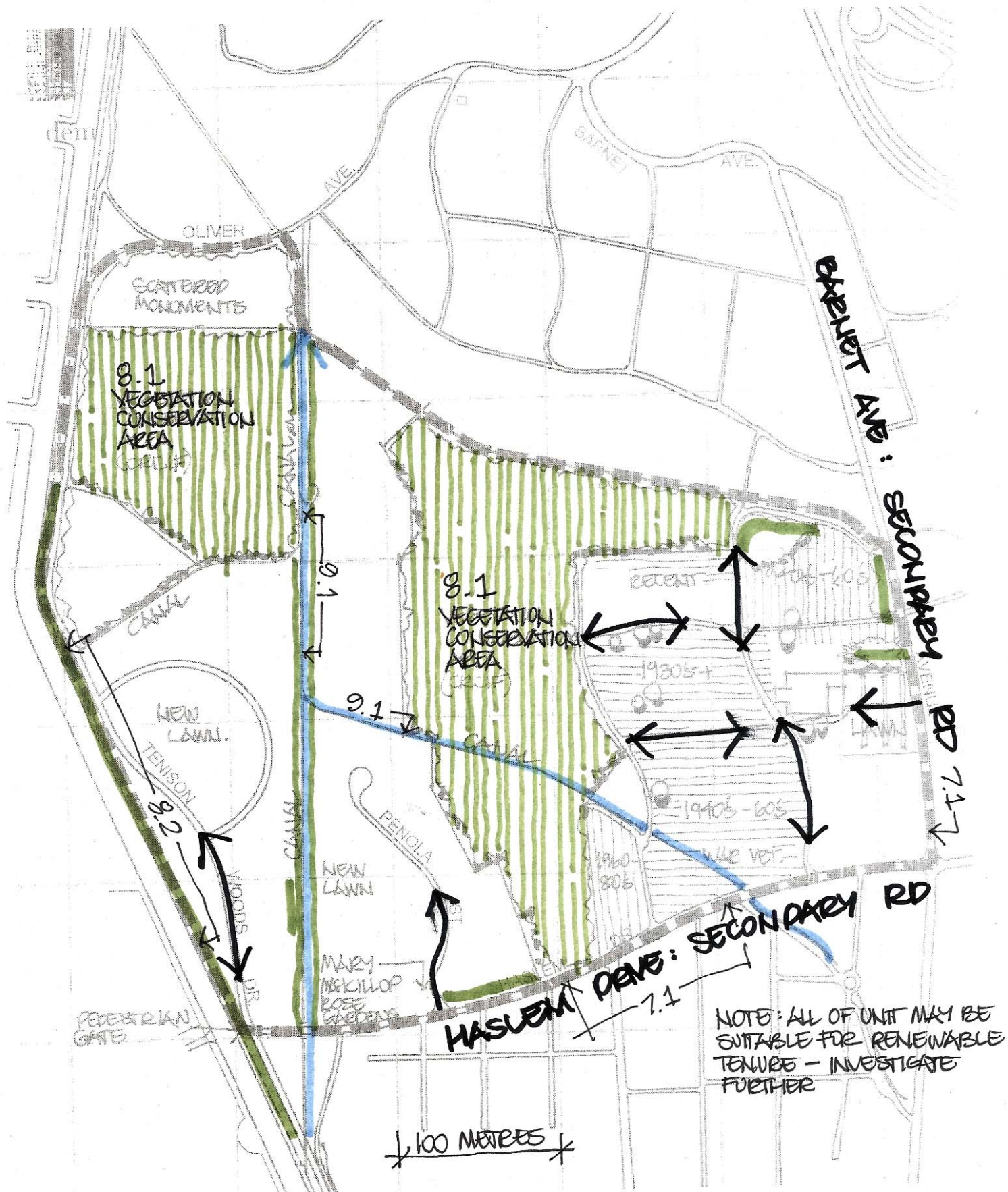

Unit 11

Rookwood Necropolis

Management Unit 12 – Jewish and Independent

Description: State Heritage Register- Listed area. Significant architectural qualities, rich display of monuments, high visibility- located on ridgeline and strong connections to Unit 7- Mortuary station site. Jewish area first to be consecrated in Dec.1866. First burial to entire Rookwood Necropolis in February 1867.

Desired Future Character:

Original landscape pattern of circular brick kerbs, gutters, burial layout and orientation protected. Tree and shrub planting protected and reinforced. Significant as early Jewish burial area and highly articulated layout in both Jewish and Independent areas. Views are significant.

KEY MANAGEMENT PRIORITIES:

- **Conservation as an historic site**
Visual corridors retained.

SD 1 Adopt sustainable management practices

P12 Identify opportunities for additional burial places, whilst maintaining Rookwood wide values- heritage, social, visual, vegetation and ecological.

12.1 The Unit is in SHR and is not suitable for renewable tenure.

P14 Maintain all above ground structures for safety and retention of visual and heritage values:

SD 2 Protect Rookwood's heritage and conserve its environment

P 1 Maintain Visual Corridors:

- 1.1 Maintain views south from Paton St and internal circulation routes. Views are beyond Rookwood to Cumberland Campus.
- 1.2 Maintain panoramic views north-east from ridgeline at Paton St over Anglican Unit 3 and 4 to city skyline.
- 1.3 Maintain visual connection north-west to Unit 7 and Necropolis Circuit along existing circulation routes.



P 2 Maintain Historic Circulation Routes including setting and material fabric:

- 2.1 Maintain all existing circulation paths including heritage brick edges, kerbs and gutters.

P3 Maintain landscape pattern of areas within State Heritage Register (SHR):

- 3.1 Maintain detailed parterres and geometric grave setout/orientation - in particular circular arrangements.
- 3.2 Maintain all of the Unit according to heritage requirements of SHR.

P4 Maintain landscape design including influences of prominent individuals:

- 4.1 Maintain circulation layout/parterres, representative of Charles Moore plan (1868).

P5 Maintain heritage monuments, features, landmarks of artistic, creative and technical value including their settings:

- 5.1 Maintain all heritage monuments.
- 5.2 Maintain Independent Office and its setting, including circulation access, and monuments surrounding office.

P6 Interpret significant heritage features and/or heritage items no longer present:

- 6.1 Investigate further through heritage study.

Management Unit 12 – Jewish and Independent

P7 Implement and reinforce established street hierarchy- primary, secondary, tertiary.

- 7.1 Maintain the Primary Roads- Necropolis Circuit and Necropolis Drive by retaining street trees, managing/ replacing when necessary through a tree maintenance strategy.

P8 Maintain significant trees/vegetation/ botanical items of rarity- refer Significant Tree Register and threatened species:

- 8.1 Maintain the significant trees within the Unit including all mature pines, palms and Eucalypts, particularly trees leading to Necropolis Circuit and along circulation routes.
- 8.2 Undertake accurate and respectful implementation of religious requirements in tree planting and management actions.
- 8.3 Tree management needs to take account of the Jewish law Halacha that determines where trees are to be planted and maintained.

P 10 Recognise high points and ridgelines: visually prominent areas:

- 10.1 Protect the ridgeline through the centre of the Unit following Paton St maintain free of structures. Consult guidelines for ridgelines (to be prepared).

SD 4 Respect cultural diversity and equitable allocation of resources

P11 Maintain representative examples of social/religious group burial practices:

- 11.1 Retain and protect areas identified in the social mapping study.
- 11.2 Respect the autonomy and individuality of each faith in all activities.



dem

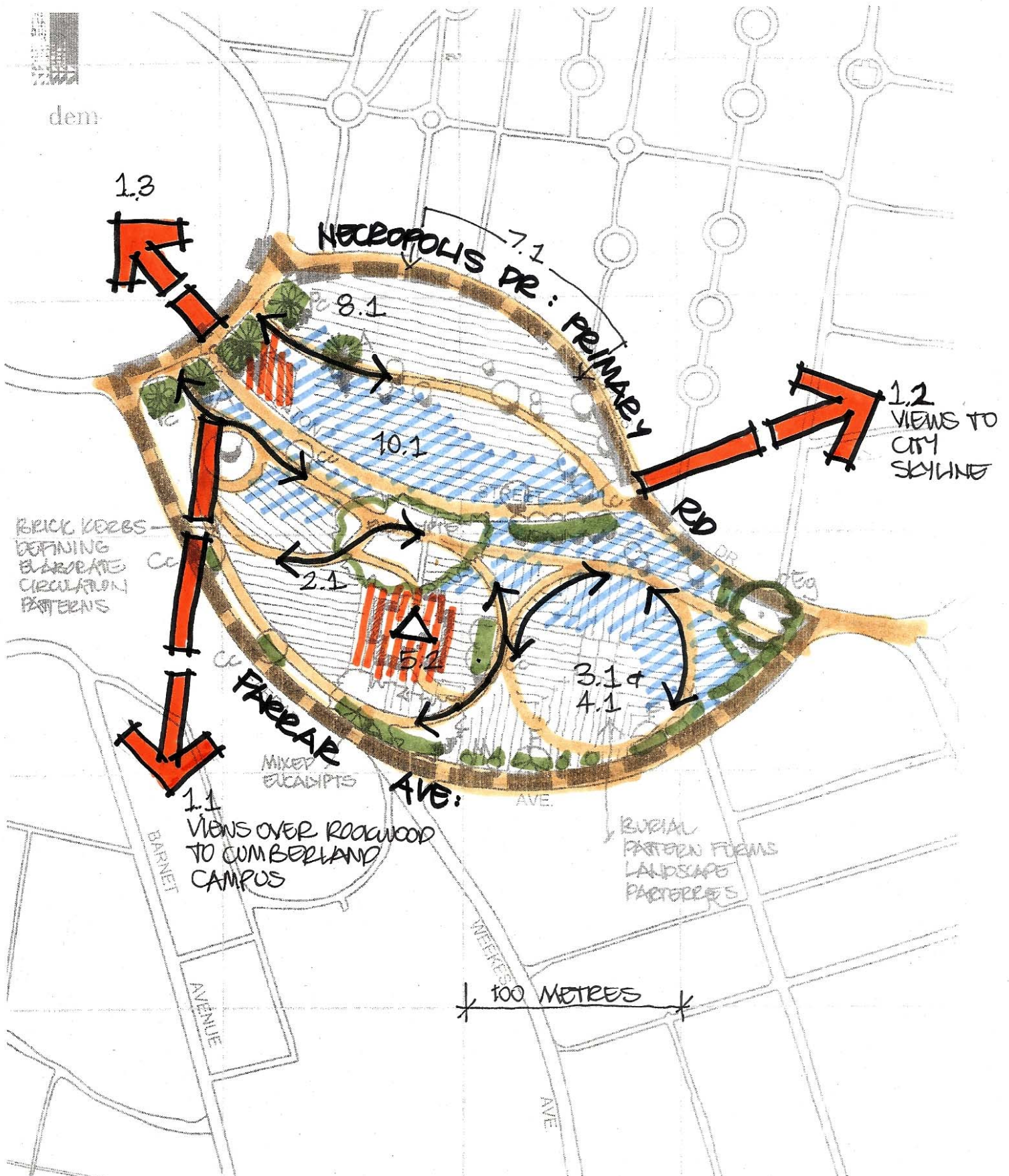

Unit 12

Rookwood Necropolis

Management Unit 13 - Independent

Description: A large unit including varied Independent areas - Russian Orthodox, Muslim, Salvation Army, Greek Orthodox, Ukrainian Orthodox. Railway alignment visible in parts with Railway culvert remaining on Barnet Ave. Russian Shrine provides landmark on ridge. Vegetation Conservation Area located centrally within valley of this visually enclosed unit.

Desired Future Character:

Tree avenue following railway alignment protected and reinforced. Railway alignment interpreted, railway culvert identified, Vegetation Conservation Area protected, burials sensitive to social groupings, quality and views from unifying ridgeline on edges maintained, Russian Shrine maintained as focal point, trees reinforced.

KEY MANAGEMENT PRIORITIES:

- **Cemetery purposes** - burial in areas to be identified, identification of opportunities to intensify use and/or introduce renewable interment rights.
- **Vegetation Conservation Area** maintained in accordance with PMP.

SD 1 Adopt sustainable management practices

P12 Identify opportunities for additional burial places, whilst maintaining Rookwood wide values- heritage, social, visual, vegetation and ecological.

- 12.1 The Unit may be suitable for additional burial in the areas of early to mid 20th Century burials- investigate further.
- 12.2 The Unit is not fully buried in the ridge area adjacent to Hawthorne and Weekes Ave, close to Hawthorne Ave, railway corridor, lawn area west of St Athanasius Chapel- Investigation of options in these areas could occur.
- 12.3 Avoid isolated infill to reduce conflicts if entire areas of renewable tenure are proposed.
- 12.4 Explore 'natural burial' whilst maintaining the Vegetation Conservation zone in the central area.

P14 Maintain all above ground structures for safety and retention of visual and heritage values:



SD 2 Protect Rookwood's heritage and conserve its environment

P 1 Maintain Visual Corridors:

- 1.1 Maintain panoramic views beyond Rookwood to the Chatswood skyline and Olympic stadium from the ridge at Weekes Ave.
- 1.2 Maintain internal views over the valley of Rookwood from the ridge at Weekes Ave.
- 1.3 Maintain views from the ridge at Hawthorne Ave over the valley of Rookwood, to the district beyond.
- 1.4 Maintain views south from northern area approaching Unit 7 along the Railway corridor alignment. Maintain the treed edge to this view as a reinforcement of the corridor.
- 1.5 Maintain views adjacent to Barnet Ave from the ridge looking north along the Railway corridor alignment.
- 1.6 Maintain panoramic views from Carpenter Ave at the intersection with Haslem Dr west over the Rookwood valley.

P 2 Maintain Historic Circulation Routes including setting and material fabric:

- 2.1 Maintain railway alignment as an interpretive element and identify the railway culvert as a heritage item to tell the story of rail transport.

Management Unit 13 - Independent

P5 Maintain heritage monuments, features, landmarks of artistic, creative and technical value including their settings:

- 5.1 Maintain Russian Shrine and its views west over the valley.

P6 Interpret significant heritage features and/or heritage items no longer present:

- 6.1 Interpret the railway corridor through the entire Unit. Establish interpretation guidelines through all Units to ensure consistency. Define Trust boundary with Unit 9.
- 6.2 Preclude large bulky structures on the railway alignment that visually screens views along the alignment.

P7 Implement and reinforce established street hierarchy- primary, secondary, tertiary.

- 7.1 Implement the established road hierarchy for Weekes Ave- primary road, Barnet Ave, Haslem Dr, Hawthorne Ave- secondary roads- plant and manage trees as part of a Tree management policy.

P8 Maintain significant trees/vegetation/ botanical items of rarity- refer Significant Tree Register and threatened species:

- 8.1 Maintain Vegetation Conservation Areas according to PMP.

P9 Maintain historic serpentine and canal:

- 9.1 Maintain canals in accordance with canal study.

P 10 Provide special consideration to High points and ridgelines: visually prominent areas:

- 10.1 Hawthorne Ave, Weekes Ave and Haslem Drive from Carpenter Ave to Necropolis Dr are all visually prominent ridges requiring special design in any proposals. (architectural guidelines to be developed)

SD 4 Respect cultural diversity and equitable allocation of resources

P11 Maintain representative examples of social/religious group burial practices-areas identified in social significance study:

- 11.1 Retain and protect areas in accordance with social mapping- Orthodox burials, early Muslim burials at Rookwood, Salvation Army, Circle of Love children's area and the Baby lawn are all areas for consideration of social value.

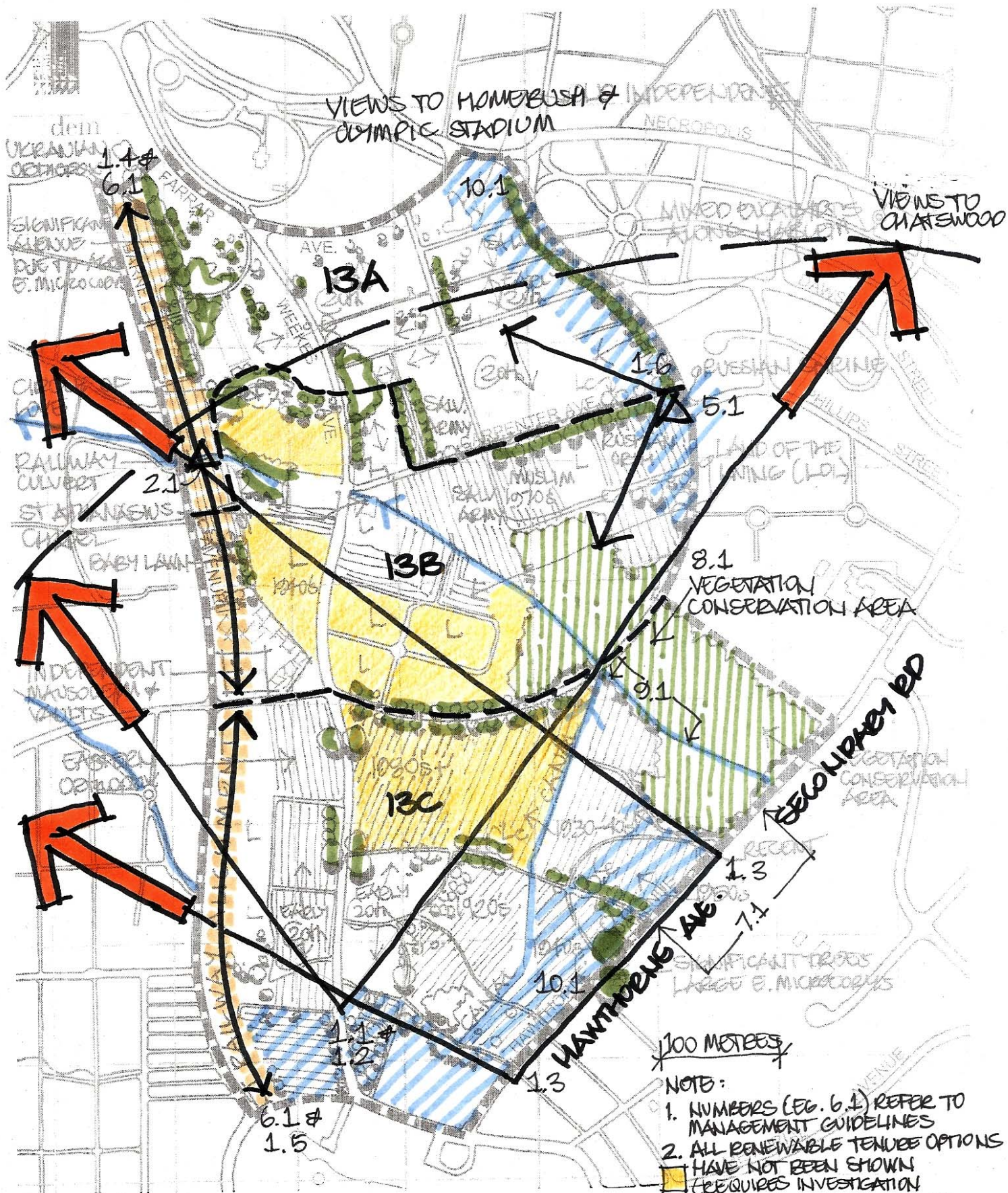

Unit 13

Rookwood Necropolis

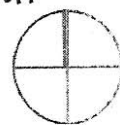

Management Unit 14 - Jewish

Description: Includes the only Jewish Cemetery in use in Sydney pre WW2. Pattern of burial & vegetation reflects distinct periods of design. North-western area- features, layout and monuments of high conservation value.

Desired Future Character:

The cultural and historical significance of Area 14A west maintained with possible listing on the SHR. Vegetation protected and reinforced along edges and streets; complimentary infill/ burial whilst respecting the cultural/religious requirements.

KEY MANAGEMENT PRIORITIES:

- Cemetery Purposes
- Heritage Conservation

SD 1 Adopt Sustainable Management Practices

P12 Identify opportunities for additional burial places, whilst maintaining Rookwood wide values- heritage, social, visual, vegetation and ecological.

- 12.1 Respect faiths that do not support renewable tenure and comply with religious requirements.
- 12.2 Identify internal circulation routes for potential closure and burial in 14A east and 14B.
- 12.3 Unit 14C new burial area: Ensure surrounding trees are retained to soften this area - establish trees where possible within the burial areas.
- 12.4 Sustainable use to comply with conservation of heritage fabric.

P14 Maintain all above ground structures for safety and retention of visual and heritage values:

SD 2 Protect Rookwood's heritage and conserve its environment

P 1 Maintain Visual Corridors:

- 1.1 Maintain panoramic views west from Hawthorne Ave to the Blue Mountains.
- 1.2 Maintain internal foreground views to the heritage circular feature layout in the west of Unit 14A.
- 1.3 Maintain foreground enclosed views to the War Memorial.

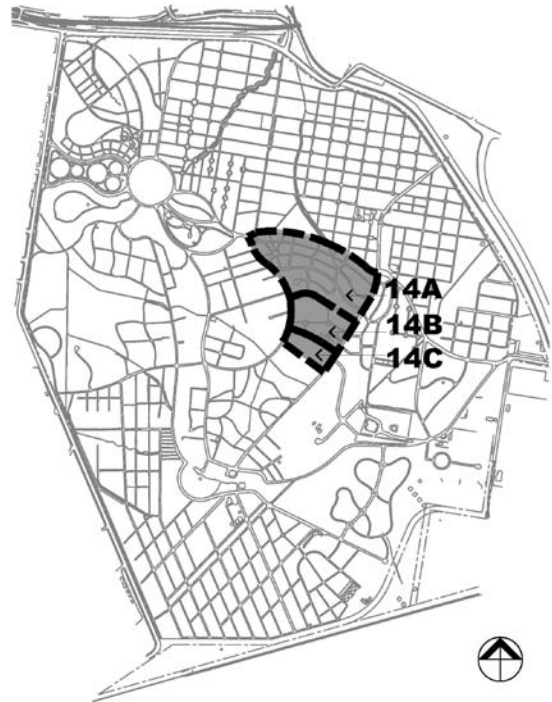

P 2 Maintain Historic Circulation Routes including setting and material fabric:

- 2.1 Maintain all existing circulation paths including heritage brick edges, kerbs and gutters in the north-western area of Unit 14A.

P3 Maintain landscape pattern of areas within State Heritage Register (SHR):

- 3.1 Consider nomination of area 14A noted in 2.1 above for SHR.

P5 Maintain heritage monuments, features, landmarks of artistic, creative and technical value including their settings:

- 5.1 Maintain all heritage monuments.
- 5.2 Maintain & protect all monuments in north- west Unit 14A including burial pattern.

P7 Implement and reinforce established street hierarchy- primary, secondary, tertiary.

- 7.1 Maintain primary road- Necropolis Dr, and secondary road- Hawthorne Ave- by retaining street trees. RNT will replace via a tree management policy.
- 7.2 Maintain Haslem Dr and Phillip St as secondary roads by implementing road profile- RNT.

Management Unit 14 - Jewish

P8 Maintain significant trees/vegetation/ botanical items of rarity- refer Significant Tree Register and threatened species:

- 8.1 Maintain the significant trees and replace via an ongoing tree planting program.
- 8.2 Undertake accurate and respectful implementation of religious requirements in tree planting and management actions.
- 8.3 Tree management needs to take account of the Jewish law Halacha that determines where trees are to be planted and maintained.
- 8.4 Protect all Threatened species- refer PMP.
- 8.5 Protect Vegetation Conservation Area to south by controlling nutrient runoff.

P9 Maintain historic serpentine and canal:

- 9.1 Maintain canal in Unit 14A according to canal study.

P 10 Recognise high points and ridgelines - visually prominent areas:

- 10.1 Protect ridgeline on Hawthorne Ave and Haslem Drive- retain vegetation, adhere to architectural guidelines

SD 4 Respect cultural diversity and equitable allocation of resources

P11 Maintain representative examples of social/religious group burial practices:

- 11.1 Retain and protect areas identified in social mapping.
- 11.2 Respect the autonomy and individuality of each faith in all activities.

Management Unit 15 - Crematorium

Description: First Cremation in 1925 saw burial's decline at Rookwood. Crematorium tower is a major landmark visible from within and outside Rookwood, reinforced as it is located on the ridgeline. Eastern area includes walled garden complimentary to the Spanish Mission style Crematorium. Significant trees are located in enclosed courtyard. Western area of open lawn and tree groupings is less developed.

Desired Future Character:

Significant trees retained and reinforced. Walled garden and setting of Crematorium Chapel retained.

KEY MANAGEMENT PRIORITIES:

- **Crematorium Purposes:** Further opportunities for intensification of use.

SD 1 Adopt Sustainable Management Practices

P12 Identify opportunities for additional burial places, whilst maintaining Rookwood wide values- heritage, social, visual, vegetation and ecological.

- 12.1 Areas that may be suitable for renewal - the area of niche walls.
- 12.2 Unit 15A is undeveloped at present and suitable for additional use.

P14 Maintain all above ground structures for safety and retention of visual and heritage values:

SD 2 Protect Rookwood's heritage and conserve its environment

P 1 Maintain Visual Corridors:

- 1.1 Maintain sightlines to the Crematorium tower located on Rookwood's ridge from the surrounding Units.
- 1.2 Maintain internal views from Memorial Ave to the tower.
- 1.3 Maintain foreground enclosed views within the main precinct of the walled garden and Chapel.

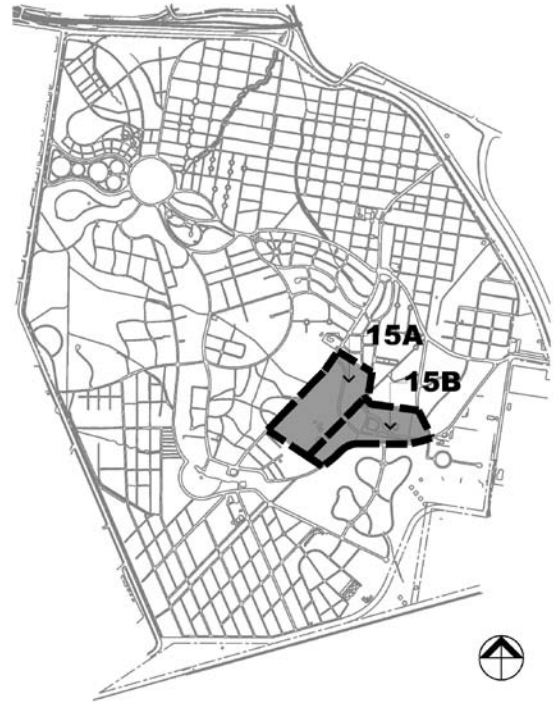

P4 Maintain landscape design including influences of prominent individuals:

- 4.1 Maintain integrity of landscape design characteristics of the Spanish Mission building and walled garden.

P5 Maintain heritage monuments, features, landmarks of artistic, creative and technical value including their settings:

- 5.1 Refer 4.1.

P6 Interpret significant heritage features and/or heritage items no longer present:

- 6.1 Review opportunities for interpreting or marking the alignment of the railway in this Unit.

P7 Implement and reinforce established street hierarchy- primary, secondary, tertiary.

- 7.1 Maintain the Primary Road- Memorial Ave, by retaining street trees and replacing any when required through a tree maintenance program.
- 7.2 Establish tree planting and profile along Hawthorne Ave- Secondary Road along the edge of Unit 15.

Management Unit 15 - Crematorium

P8 Maintain significant trees/vegetation/ botanical items of rarity- refer Significant Tree Register and threatened species:

- 8.1 Maintain the significant trees within the Unit – some include *Eucalyptus citriodora* in walled garden, *Eucalyptus microcorys* on Hawthorne Ave, *Jacaranda* avenue in walled garden,. Investigate further as part of Significant Tree register along with garden specimens- ie rose gardens.

P 10 Recognise high points and ridgelines - visually prominent areas:

- 10.1 The ridgeline on which the Crematorium sits is the high point of Rookwood and visually prominent from all of Rookwood and the district beyond- adhere to architectural guidelines (to be developed) for ridgeline structures.

SD 4 Respect cultural diversity and equitable allocation of resources

P11 Maintain representative examples of social/religious group burial practices:

- 11.1 Retain and protect areas identified in social mapping
- 11.2 Respect the autonomy and individuality of each faith in all activities.

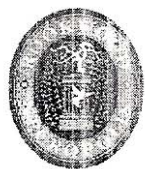
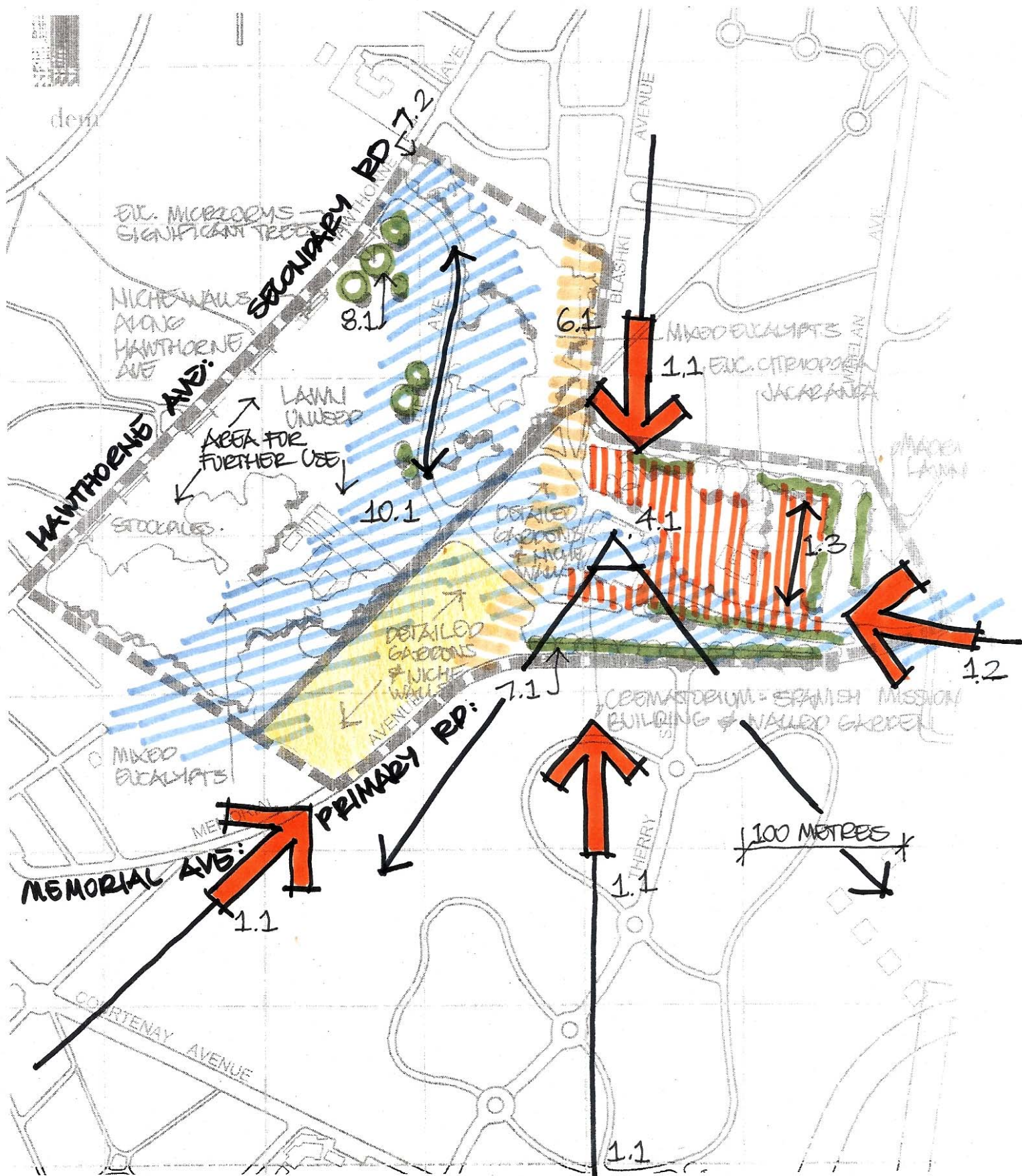

Unit 15A & 15B **Rookwood Necropolis**

Management Unit 16 - Lutheran

Description: Located on the ridge; burial from 1890's commenced. Rectilinear, enclosed courtyards, defined by trees and hedges. Intimate in scale with garden character. World War 1 memorial is a focal point on the central axial path.

Desired Future Character:

Trees and enclosed outdoor 'rooms' retained.

KEY MANAGEMENT PRIORITIES:

- **Cemetery purposes** - burial in areas to be identified, identification of opportunities to intensify use and/or introduce renewable interment rights.

SD 1 Adopt Sustainable Management Practices

P12 Identify opportunities for additional burial places, whilst maintaining Rookwood wide values- heritage, social, visual, vegetation and ecological.

- 12.1 Areas may be suitable for additional burial in accordance with social mapping.
- 12.2 Further burial is occurring within the lawn area in the east of the Unit and can be maximised.

P14 Maintain all above ground structures for safety and retention of visual and heritage values:

SD 2 Protect Rookwood's heritage and conserve its environment

P 1 Maintain Visual Corridors:

- 1.1 Maintain views into the Unit along circulation routes. In particular maintain the view along the axis to the WW1 Memorial.

P5 Maintain heritage monuments, features, landmarks of artistic, creative and technical value including their settings:

- 5.1 Maintain WW1 memorial and its circular setting.

P7 Implement and reinforce established street hierarchy- primary, secondary, tertiary.

- 7.1 Maintain the Primary Road- Memorial Ave, by retaining street trees and replacing any when necessary through a tree maintenance program.



- 7.2 Establish tree planting and profile along Hawthorne Ave- Secondary Road along the edge of Unit 16.

P8 Maintain significant trees/vegetation/ botanical items of rarity- refer Significant Tree Register and threatened species:

- 8.1 Maintain the significant trees within the Unit – some include *Eucalyptus microcorys* on Hawthorne Ave. Investigate further as part of Significant Tree register along with garden specimens.

P 10 Recognise high points and ridgelines - visually prominent areas:

- 10.1 The ridgeline on which the Lutheran Unit sits is the high point of Rookwood and visually prominent.- adhere to architectural guidelines (to be developed) for ridgeline development where applicable.

SD 4 Respect cultural diversity and equitable allocation of resources

P11 Maintain representative examples of social/religious group burial practices:

- 11.1 Retain and protect areas identified in social mapping.

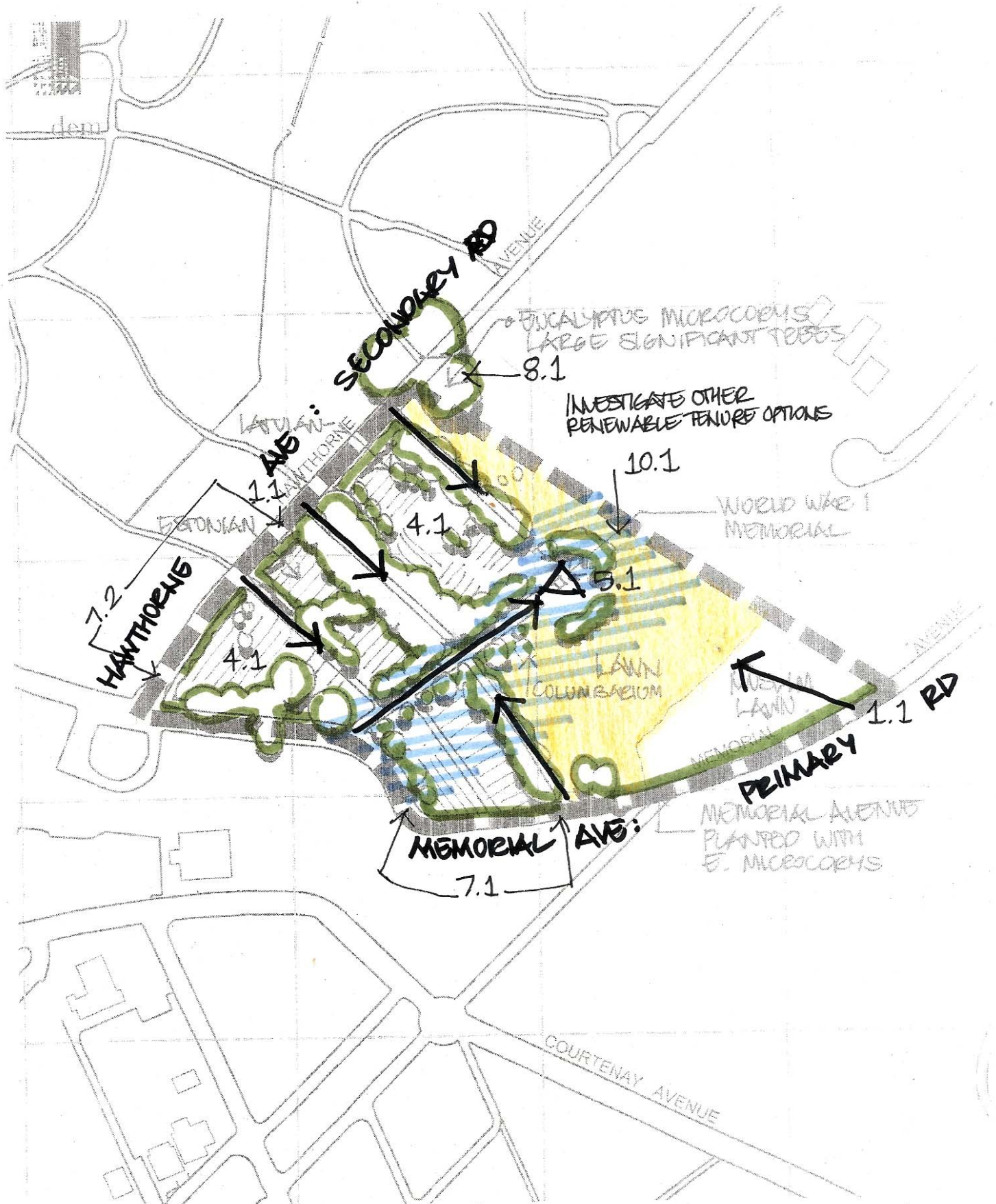

Unit 16

Rookwood Necropolis



Management Unit 17 - Catholic and Lutheran

Description: Mortuary Station No. 3 completed in this area in 1897- footings remain. Administrative centre of Catholic Cemetery. Mausoleum, Chapel, Crematorium and Condolences lounge located on major ridgeline with views south. Lawn burial radiates from 'Crown of Thorns' shrine, a landmark on the ridge.

Desired Future Character:

Importance of the visibility of this ridgeline identified- any structure on it is highly visible. Trees reinforced on ridge, views retained. Railway alignment and station footings interpreted.

KEY MANAGEMENT PRIORITIES:

- **Cemetery purposes** - burial in areas to be identified, identification of opportunities to intensify use and/or introduce renewable interment rights.
- **Heritage Conservation**- Mortuary Station footings and location.

SD 1 Adopt Sustainable Management Practices

P12 Identify opportunities for additional burial places, whilst maintaining Rookwood wide values- heritage, social, visual, vegetation and ecological.

- 12.1 Areas that may be suitable for additional burial are lawn burial areas and those not selected in the social mapping.
- 12.2 Further burial may occur in the Lutheran area and the interpretation corridor of the railway alignment., subject to heritage compliance.
- 12.3 The bus turn around area could accommodate burial when this is relocated.

P14 Maintain all above ground structures for safety and retention of visual and heritage values:

SD 2 Protect Rookwood's heritage and conserve its environment

P 1 Maintain Visual Corridors:

- 1.1 Maintain views south along circulation routes in Unit 18B.
- 1.2 Maintain views along the alignment of the railway.



P 2 Maintain Historic Circulation Routes including setting and material fabric:

- 2.1 Maintain railway alignment as an interpretive element and recognise the railway footings as a heritage item that assists in telling the story of rail transport at Rookwood.

P5 Maintain heritage monuments, features, landmarks of artistic, creative and technical value including their settings:

- 5.1 Maintain the status of the structures- Crown of Thorns Shrine and the Mausoleum as features within this Unit..

P6 Interpret significant heritage features and/or heritage items no longer present:

- 6.1 Review opportunities for interpreting or marking the alignment of the railway in this Unit.

P7 Implement and reinforce established street hierarchy- primary, secondary, tertiary.

- 7.1 Maintain the Primary Road- Memorial Ave, by retaining street trees and replacing any when necessary through a tree maintenance program.
- 7.2 Establish tree planting and profile along Barnet Ave- Secondary Road along the edge of Unit 17.

Management Unit 17 - Catholic and Lutheran

P8 Maintain significant trees/vegetation/ botanical items of rarity- refer Significant Tree Register and threatened species:

- 8.1 Maintain the significant trees within the Unit as part of Significant Tree register along with garden specimens.

P 10 Recognise high points and ridgelines - visually prominent areas:

- 10.1 The ridgeline of the entire Unit is a high point of Rookwood and visually prominent.- adhere to architectural guidelines (to be developed) for ridgeline development.

SD 4 Respect cultural diversity and equitable allocation of resources

P11 Maintain representative examples of social/religious group burial practices:

- 11.1 Retain and protect areas identified in social mapping.

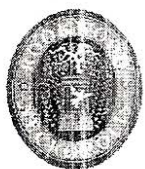
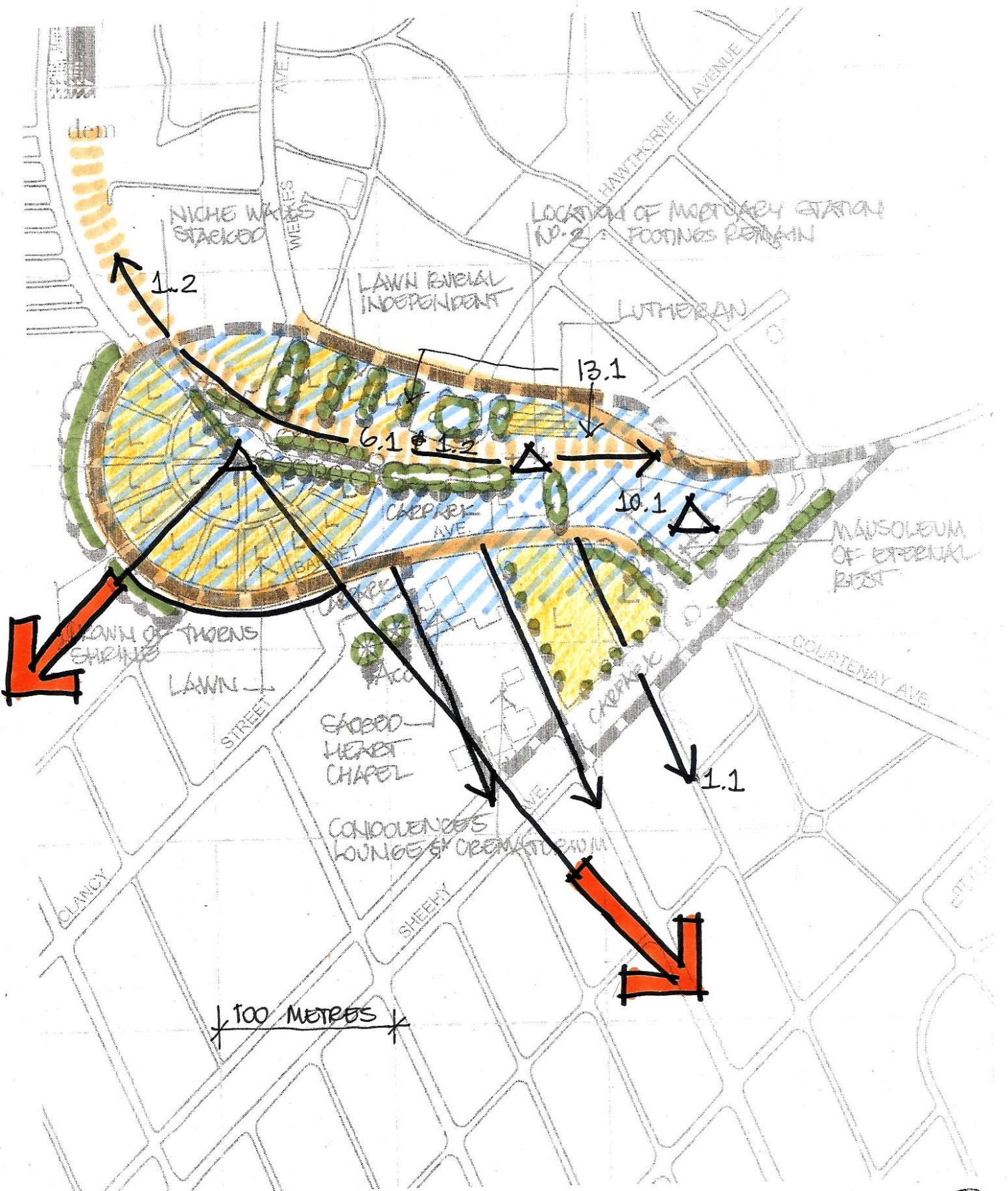

Unit 17

Rookwood Necropolis

Management Unit 18 - Catholic

Description: Located south of the main Rookwood ridgeline, includes large variety of 20th Century burials- Croatian, Melkite, Ukrainian, Slovene, Maronite- mostly post 1940's. Large areas of lawn burials with crypts in the south. Brushbox and Canary Is. Date palms line the streets in part. Lewisham Cemetery monuments relocated here.

Desired Future Character:

Tree avenues and pattern of circulation retained. Lewisham monuments protected and maintained. Additional tree planting to define and soften areas, and reinforce aging/declining trees. View along Sheehy Ave retained in both directions, as a significant avenue.

KEY MANAGEMENT PRIORITIES:

- **Cemetery purposes** - burial in areas to be identified, identification of opportunities to intensify use and/or introduce renewable interment rights.

SD 1 Adopt Sustainable Management Practices

P12 Identify opportunities for additional burial places, whilst maintaining Rookwood wide values- heritage, social, visual, vegetation and ecological.

- 12.1 Areas that may be suitable for additional burial are slab and desk areas, lawn burial areas and those not selected in the social mapping.
- 12.2 Further burial may occur in the undeveloped areas.
- 12.3 Burial within every second road within the grid could occur.

P14 Maintain all above ground structures for safety and retention of visual and heritage values:

SD 2 Protect Rookwood's heritage and conserve its environment

P 1 Maintain Visual Corridors:

- 1.1 Maintain views south along circulation routes.
- 1.2 Maintain views along Sheehy Ave, defined by the new street trees and arrangement.

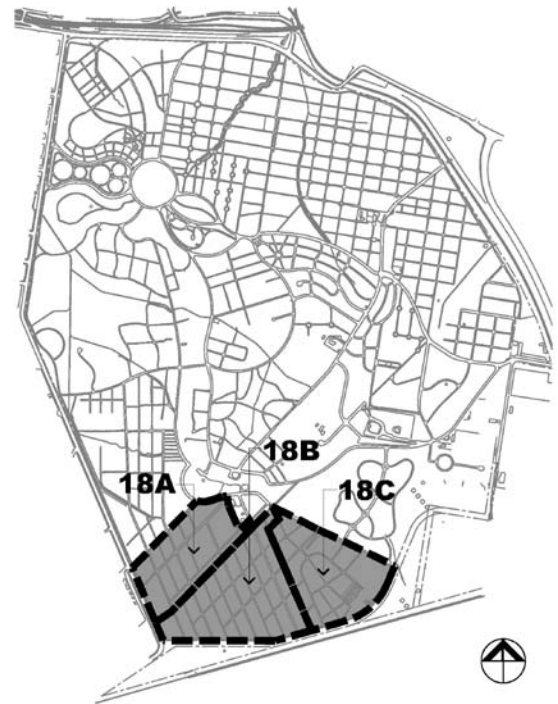

P5 Maintain heritage monuments, features, landmarks of artistic, creative and technical value including their settings:

- 5.1 Maintain and assess condition of Lewisham monuments.

P7 Implement and reinforce established street hierarchy- primary, secondary, tertiary.

- 7.1 Maintain the Secondary Roads – Sheehy Ave, Courtenay Ave, by retaining street trees and replacing any when necessary through a tree maintenance program.

P8 Maintain significant trees/vegetation/ botanical items of rarity- refer Significant Tree Register and threatened species:

- 8.1 Maintain the significant trees within the Unit as part of Significant Tree register.
- 8.2 Maintain and reinforce boundary planting along East St

P 10 Recognise high points and ridgelines - visually prominent areas:

- 10.1 The ridgeline of the entire Unit is a high point of Rookwood and visually prominent- adhere to architectural guidelines (to be developed) for ridgeline development.

SD 4 Respect cultural diversity and equitable allocation of resources

P11 Maintain representative examples of social/religious group burial practices:

- 11.1 Retain and protect areas identified in social mapping.

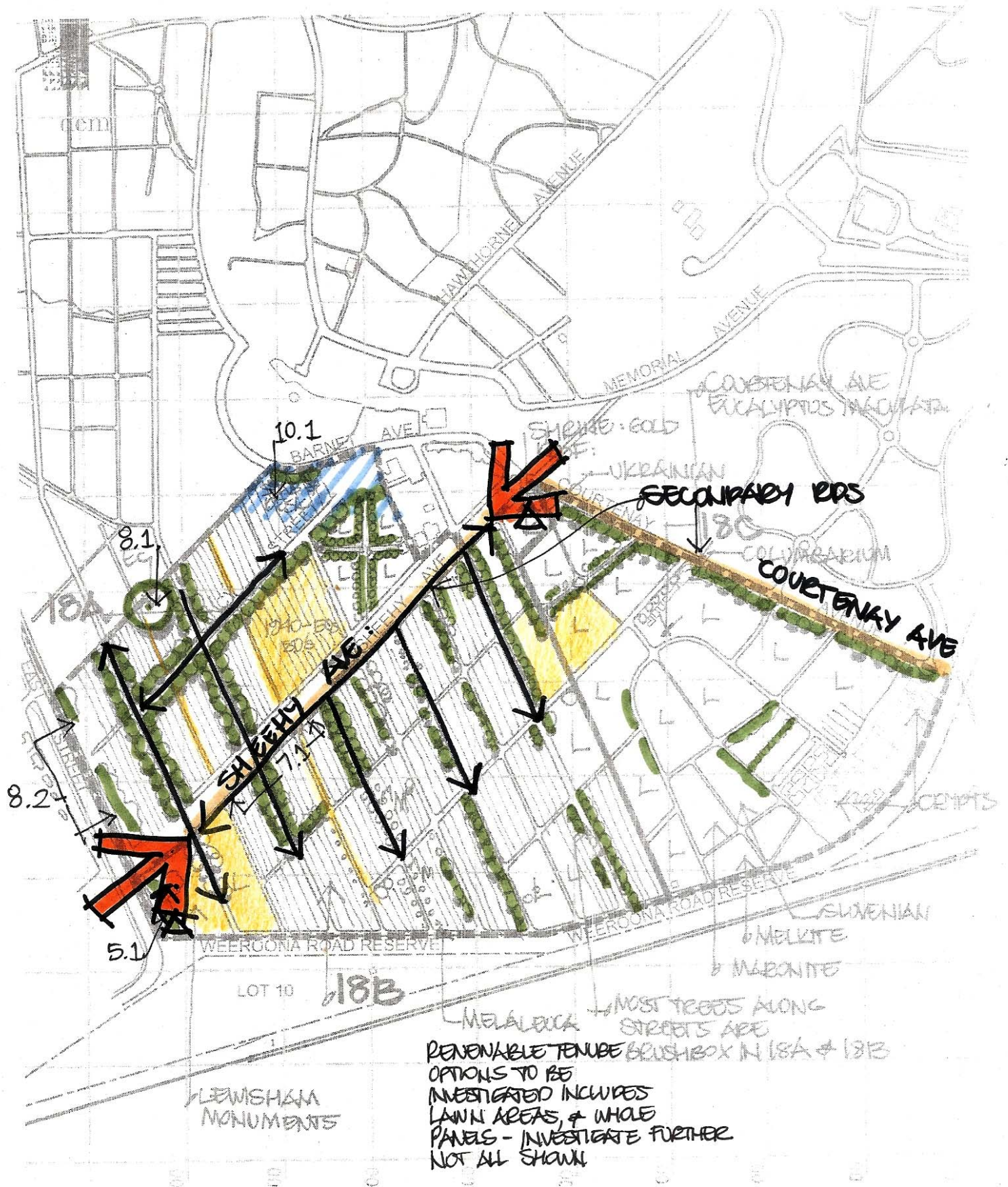

Units 18A, 18B & 18C Rookwood Necropolis



Management Unit 19 - Catholic

Description: Recent 1980's development, with tree avenues lining circular road pattern. Well defined and enclosed by vegetation with central water feature in gully. New pavilion at top of gully provides a focus.

Desired Future Character:

Enclosed landscape character retained with tree avenues retained.

KEY MANAGEMENT PRIORITIES:

- **Cemetery purposes** - burial in areas to be identified, identification of opportunities to intensify use and/or introduce renewable interment rights.

SD 1 Adopt sustainable management practices

P12 Identify opportunities for additional burial places, whilst maintaining Rookwood wide values- heritage, social, visual, vegetation and ecological.

12.1 Areas that may be suitable for additional burial are lawn burial areas.

P14 Maintain all above ground structures for safety and retention of visual and heritage values:

SD 2 Protect Rookwood's heritage and conserve its environment

P 1 Maintain Visual Corridors:

- 1.1 Maintain view along 'Way of the Cross memorial gardens' water feature.
- 1.2 Maintain screening vegetation in the south and east to the transmission towers.

P4 Maintain landscape design including influences of prominent individuals:

- 4.1 Design of this Unit is unique in road layout and could be retained as a representative style of road pattern of the 80-90's.

P7 Implement and reinforce established street hierarchy- primary, secondary, tertiary.

- 7.1 Maintain the hierarchy of tree planting along the tertiary roads within this Unit.



- 7.2 Maintain Memorial Ave- Secondary roads by maintaining tree planting and manage trees as part of a Tree management policy.

P8 Maintain significant trees/vegetation/ botanical items of rarity- refer Significant Tree Register:

- 8.1 Maintain the significant trees within the Unit in accordance with the significant tree register.

P9 Maintain historic serpentine and canal:

- 9.1 No canals exist, maintain the function of the drainage gully and address the discharge of drainage into Lot 7053.

P 10 Provide special consideration to High points and ridgelines: visually prominent areas:

- 10.1 Protect the ridgeline on Memorial Ave by retaining vegetation and adhering to architectural guidelines (to be prepared) for ridgeline development.

SD 4 Respect cultural diversity and equitable allocation of resources

P11 Maintain representative examples of social/religious group burial practices-areas identified in social significance study:

- 11.1 Retain and protect areas identified elsewhere in the social mapping study.



Unit 19 **Rookwood Necropolis**

Management Unit 20 – Anglican and Jewish

Description: Mortuary Station No. 4 completed in 1908- no longer present with alignment of railway fully buried in Jewish area. Mostly 20th Century burials with Chinese pavilion as a landmark in the centre. Few trees are present, large area of Chinese monumental burials. Trees along Whelan Avenue are important visual definition. The ridge on Hawthorne Ave is significant with its views to the CBD.

Desired Future Character:

Panoramic views from Hawthorne Avenue to CBD retained. Views to Chinese pavilion as a central landmark retained. Additional tree planting on edges and streets to define areas.

KEY MANAGEMENT PRIORITIES:

- **Cemetery purposes** - burial in areas to be identified, identification of opportunities to intensify use and/or introduce renewable interment rights.

SD 1 Adopt sustainable management practices

P12 Identify opportunities for additional burial places, whilst maintaining Rookwood wide values- heritage, social, visual, vegetation and ecological.

- 12.1 Areas that may be suitable for additional burial are lawn burial areas.
- 12.2 Recognise the character of the Chinese burial area as a unique character in Rookwood.

P14 Maintain all above ground structures for safety and retention of visual and heritage values:

SD 2 Protect Rookwood's heritage and conserve its environment

P 1 Maintain Visual Corridors:

- 1.1 Maintain panoramic views east from Hawthorne Ave to the CBD skyline.
- 1.2 Maintain and reinforce screening vegetation as visual separation between sub- units 20A and 20B, to manage different religious group burial characteristics.
- 1.3 Transition of varied religious burial character to be managed by landscape planting, recognition of view corridors and circulation routes.

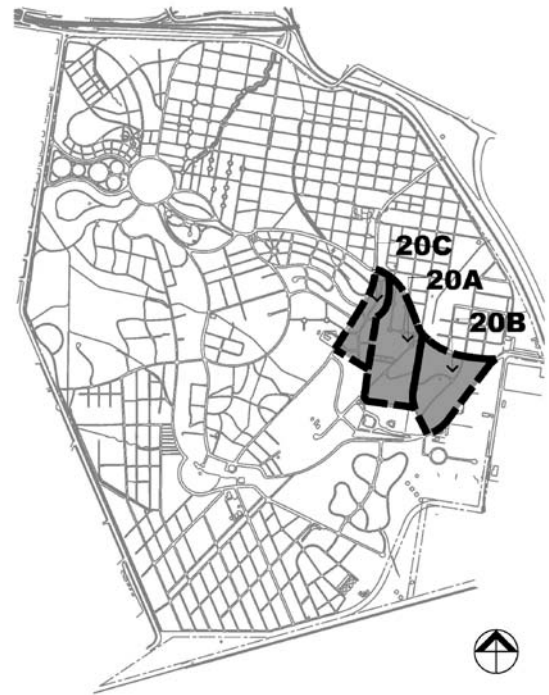

P5 Maintain heritage monuments, features, landmarks of artistic, creative and technical value including their settings:

- 5.1 Maintain Chinese pavilion as a landmark.

P6 Interpret significant heritage features and/or heritage items no longer present:

- 6.1 Introduce actions to enable the railway alignment to be interpreted.

P7 Implement and reinforce established street hierarchy- primary, secondary, tertiary.

- 7.1 Maintain Hawthorne Ave - Secondary roads by maintaining tree planting and manage/replace trees as part of a Tree management policy.
- 7.2 Maintain Memorial Ave, Necropolis Dr – Primary roads by maintaining tree planting and manage trees as part of a Tree management policy.

P8 Maintain significant trees/vegetation/ botanical items of rarity- refer Significant Tree Register:

- 8.1 Maintain the significant trees within the Unit in accordance with the significant tree register.

P 10 Provide special consideration to high points and ridgelines: visually prominent areas:

- 10.1 Protect the ridgeline on Hawthorne Ave by retaining vegetation and adhering to architectural guidelines (to be prepared) for ridgeline development.

Management Unit 20 – Anglican and Jewish

SD 4 Respect cultural diversity and equitable allocation of resources

P11 Maintain representative examples of social/religious group burial practices-areas identified in social significance study:

- 11.1 Retain and protect areas identified elsewhere in the social mapping study.
- 11.2 Respect the autonomy and individuality of each faith in all activities.

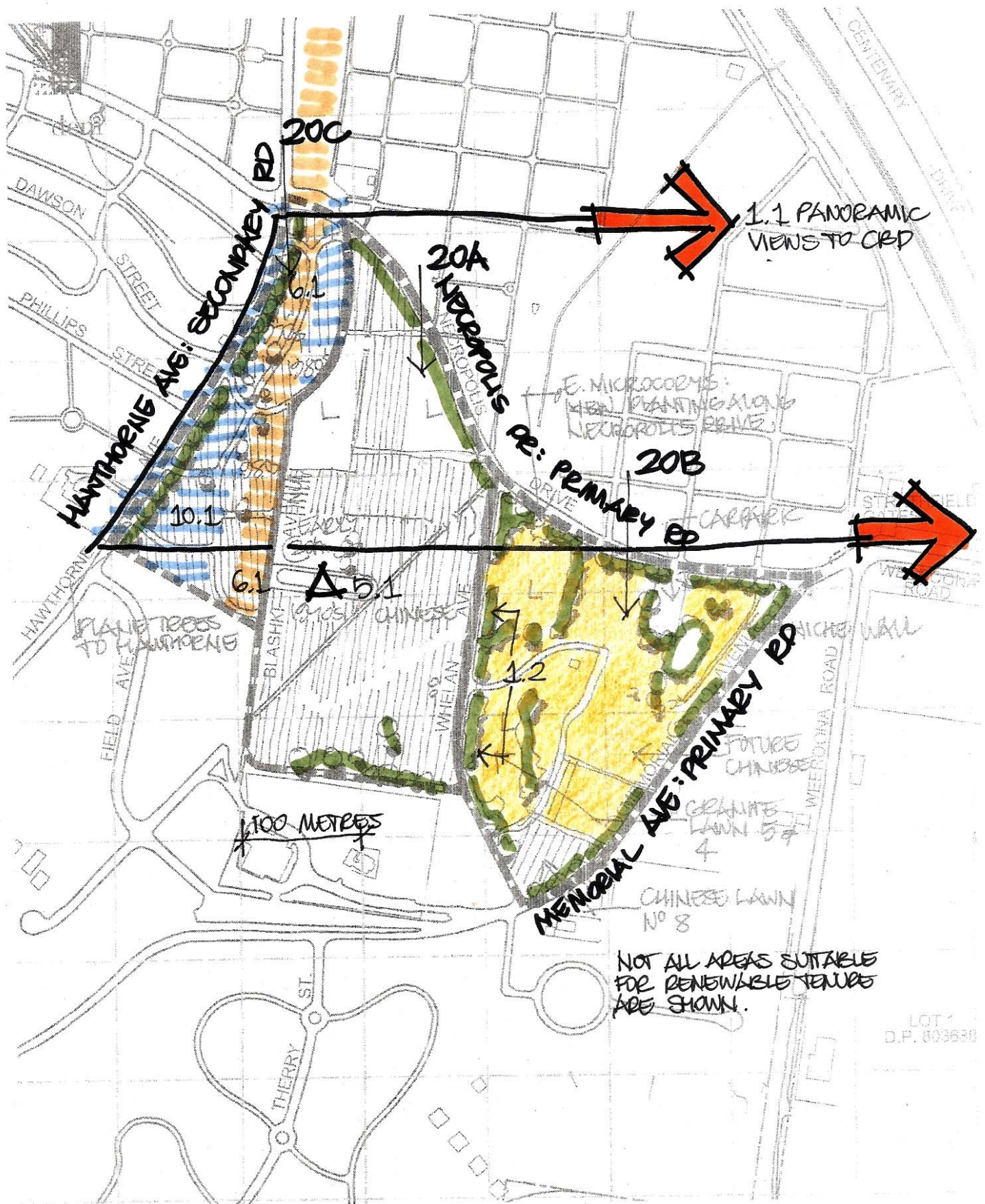

Units 20A, 20B & 20C

Rookwood Necropolis



Management Unit 21 – Sydney War Cemetery, Garden of Remembrance

Description: Immaculately maintained areas, defined by hedging and enclosed walls. Uniform lawn burial with roses and gardens defining each plot. Niche walls in Garden of Remembrance. Sandstone loggia is an attractive entry point

Desired Future Character:

Large trees defining the area retained and reinforced, character of hedged areas protected.

KEY MANAGEMENT PRIORITIES:

- **Special Cemetery purposes-** commemorating servicemen whose death can be attributed to operational service.

SD 1 Adopt sustainable management practices

P12 Identify opportunities for additional burial places, whilst maintaining Rookwood wide values- heritage, social, visual, vegetation and ecological.

- 12.1 Renewable tenure is not appropriate.
- 12.2 Areas of vacant space are not apparent and few opportunities are available for developing burial areas.

P14 Maintain all above ground structures for safety and retention of visual and heritage values:

SD 2 Protect Rookwood's heritage and conserve its environment

P 1 Maintain Visual Corridors:

- 1.1 Maintain views into War Graves and the Garden of Remembrance from Memorial Ave. as well as the treed frontage.
- 1.2 Maintain the internal axial vistas along the central circulation paths

P4 Maintain landscape design including influences of prominent individuals:

- 4.1 Maintain landscape character of War Graves including hedging to define space.



P5 Maintain heritage monuments, features, landmarks of artistic, creative and technical value including their settings:

- 5.1 Maintain the sandstone entry loggia to War Graves as a quality architectural entry.

P7 Implement and reinforce established street hierarchy- primary, secondary, tertiary.

- 7.1 Maintain Memorial Ave– Primary road by maintaining tree planting and manage/replace trees as part of a Tree management policy.

P8 Maintain significant trees/vegetation/ botanical items of rarity- refer Significant Tree Register:

- 8.1 Maintain the significant trees within the Unit in accordance with the significant tree register. Trees fronting Memorial Ave provide a significant setting.
- 8.2 Maintain and reinforce boundary planting to entire Unit.

P 10 Provide special consideration to High points and ridgelines: visually prominent areas:

- 10.1 War Graves is located on the ridgeline and is highly visible. Adhere to architectural guidelines (to be prepared) for ridgeline development.

Management Unit 21 – Sydney War Cemetery, Garden of Remembrance

SD 4 Respect cultural diversity and equitable allocation of resources

P11 Maintain representative examples of social/religious group burial practices-areas identified in social significance study:

11.1 Retain and protect all memorials in this Unit.



Unit 21 Rookwood Necropolis

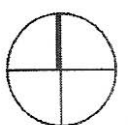

Management Unit 22 – Anglican

Description: Recent burial area dating from 1990's. Includes large monuments with few trees. Vegetation Conservation Area included in the south. Newly released area for burial in south.

Desired Future Character:

Character of social/religious group burials identified. Opportunity for additional burials. Tree planting to boundaries reinforced.

KEY MANAGEMENT PRIORITIES:

- **Cemetery purposes** - burial in areas to be identified, identification of opportunities to intensify use and/or introduce renewable interment rights.

SD 1 Adopt sustainable management practices

P12 Identify opportunities for additional burial places, whilst maintaining Rookwood wide values- heritage, social, visual, vegetation and ecological.

12.1 Areas may be suitable for additional burial.

12.2 The new area in the south of this Unit is available for burial.

P14 Maintain all above ground structures for safety and retention of visual and heritage values:

SD 2 Protect Rookwood's heritage and conserve its environment

P 1 Maintain Visual Corridors:

1.1 Maintain views into the Unit from Memorial Ave at the entry.

P7 Implement and reinforce established street hierarchy- primary, secondary, tertiary.

7.1 Maintain Memorial Ave,– Primary road by maintaining tree planting and manage trees as part of a Tree management policy.

P8 Maintain significant trees/vegetation/ botanical items of rarity- refer Significant Tree Register:

8.1 Maintain screening vegetation as visual separation between Unit 22 and Unit 19.



8.2 Maintain Vegetation Conservation Areas in accordance with PMP. Manage area in association with adjacent areas in Unit 24.

P 10 Provide special consideration to High points and ridgelines: visually prominent areas:

10.1 Protect the ridgeline adjacent to Memorial Ave by retaining vegetation and adhering to architectural guidelines (to be prepared) for ridgeline development.

SD 4 Respect cultural diversity and equitable allocation of resources

P11 Maintain representative examples of social/religious group burial practices-areas identified in social significance study:

11.1 Retain and protect areas identified elsewhere in the social mapping study.

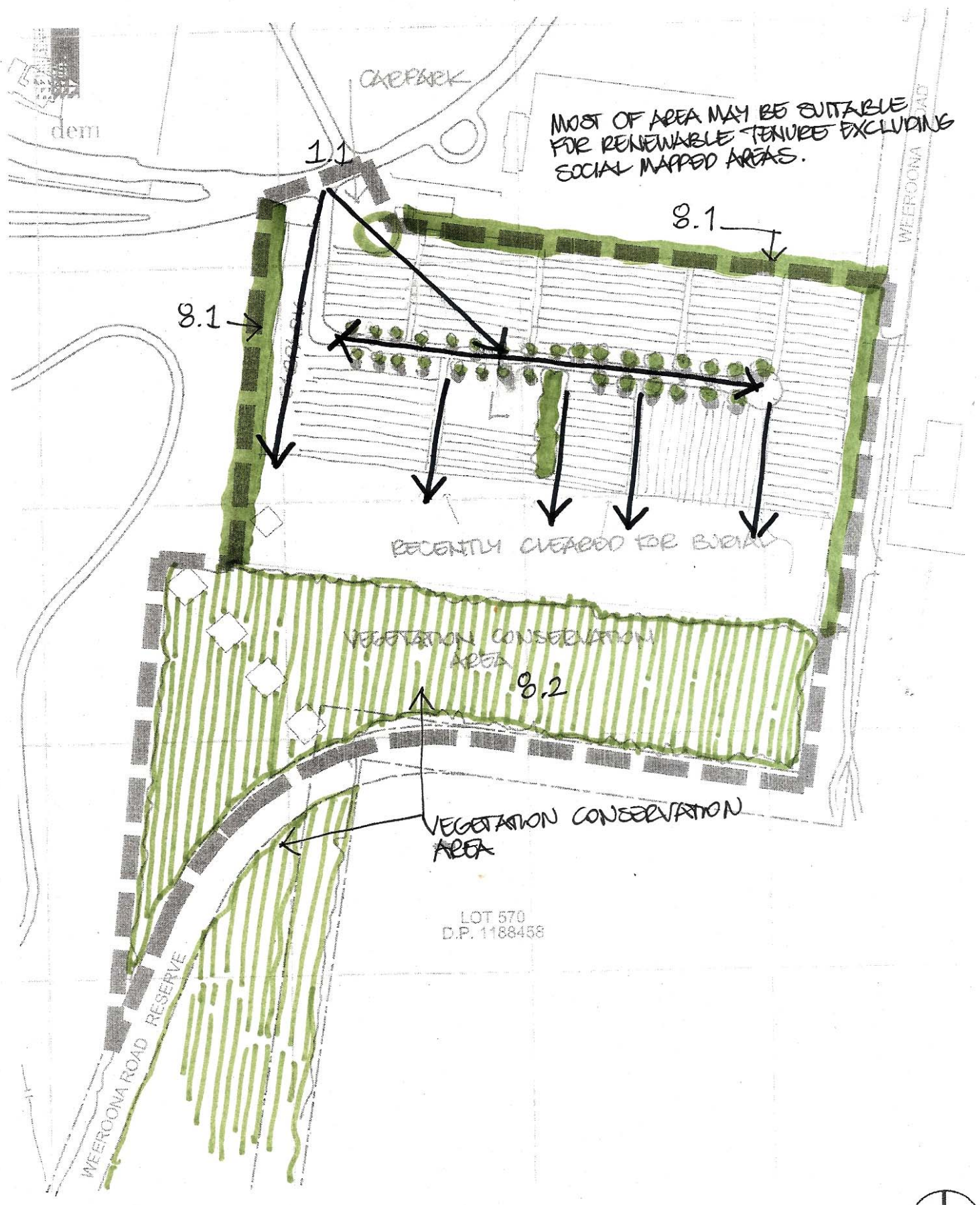

Unit 22

Rookwood Necropolis

Management Unit 23 - Muslim

Description: Dense palm planting within graves identifies area with significant cultural diversity at Rookwood. Burial orientation to Mecca- Muslim office provides orientation point. Views south into Unit from Memorial Ave.

Desired Future Character:

Cultural burial practices retained and diversity legible. New complimentary lawn burial area.

KEY MANAGEMENT PRIORITIES:

- Cemetery purposes

SD 1 Adopt Sustainable Management Practices

P12 Identify opportunities for additional burial places, whilst maintaining Rookwood wide values- heritage, social, visual, vegetation and ecological.

- 12.1 Identify areas where additional burial is possible- there are limited opportunities. New area of burial at Rookwood for Muslim Trust has been allocated in Unit 24.

P14 Maintain all above ground structures for safety and retention of visual and heritage values:

SD 2 Protect Rookwood's heritage and conserve its environment

P 1 Maintain Visual Corridors:

- 1.1 Maintain views south from Memorial Ave at entry.

P5 Maintain heritage monuments, features, landmarks of artistic, creative and technical value including their settings:

- 5.1 Identify monuments representative of Muslim burial practices to protect.

P7 Implement and reinforce established street hierarchy- primary, secondary, tertiary.

- 7.1 Maintain primary road- Memorial Ave, trees and manage as part of tree policy

P8 Maintain significant trees/vegetation/ botanical items of rarity- refer Significant Tree Register and threatened species:

- 8.1 Maintain screening vegetation as visual separation between Unit 23 and 19.



- 8.2 Manage palm/tree planting on graves- avoid overcrowding. Establish management policy – arborist input needed.
- 8.3 Undertake accurate and respectful implementation of religious requirements in tree planting and management actions.
- 8.4 Protect all Threatened species- refer PMP.

P 10 Recognise high points and ridgelines - visually prominent areas:

- 10.1 Protect visual character of new Muslim area on ridge- avoid structures.

SD 4 Respect cultural diversity and equitable allocation of resources

P11 Maintain representative examples of social/religious group burial practices

- 11.1 Retain and protect an areas of burial with palm/trees on graves as identified in social mapping.
- 11.2 Respect the autonomy and individuality of each faith in all activities.

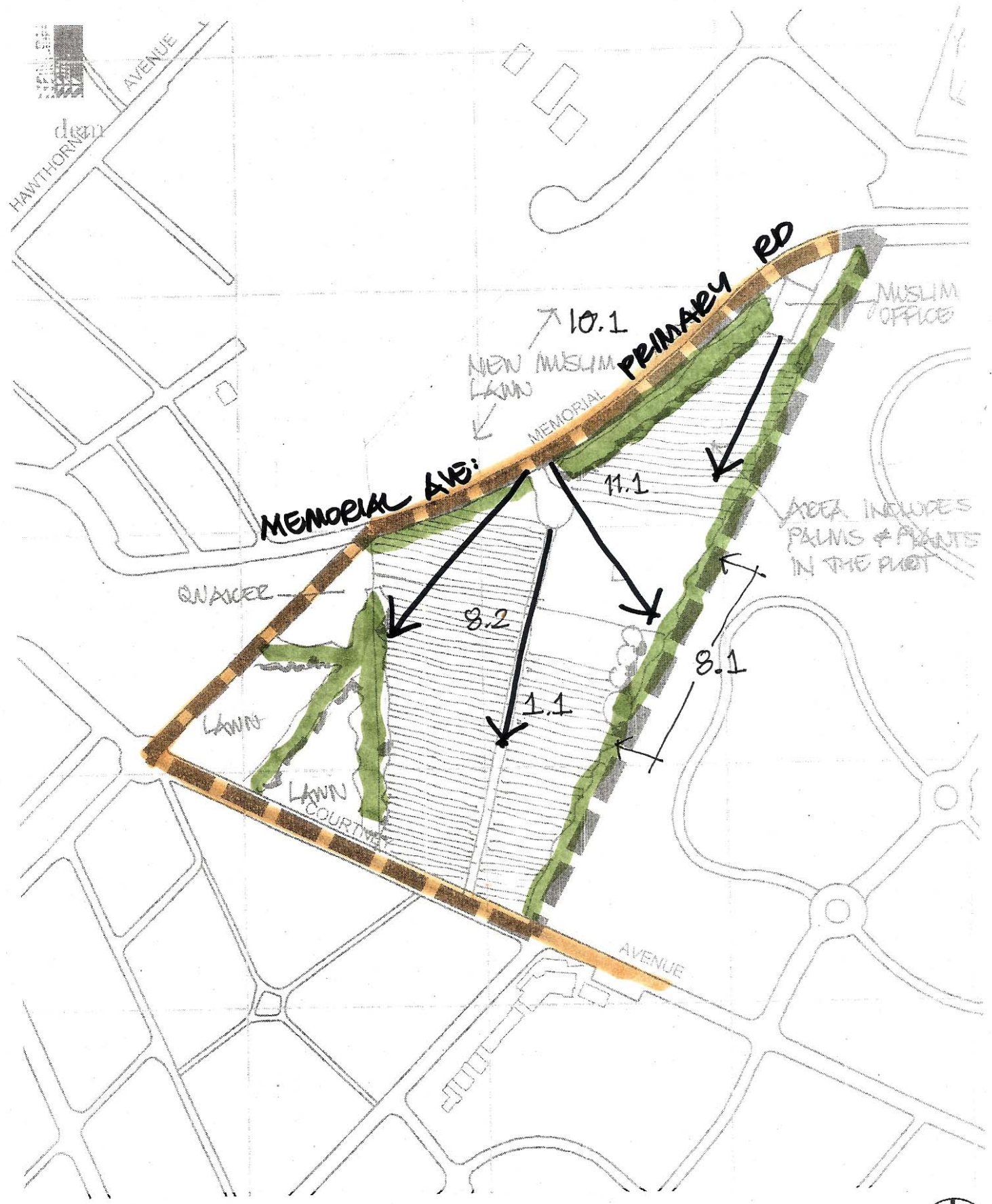

Unit 23

Rookwood Necropolis

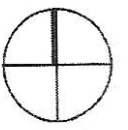

Management Unit 24 – Lot 10 and 7053

Description: New burial area in Lot 10. Open and requires additional planting to define and soften. Vegetation Conservation Area present in the east with large transmission towers overhead.

Desired Future Character:

Planted boundaries with landscape to define burial areas. Railway boundary treed to screen industrial areas beyond.

KEY MANAGEMENT PRIORITIES:

- **Cemetery Purposes-** new burial in Lot 10
- **Vegetation Conservation Area** maintained in accordance with PMP

SD 1 Adopt sustainable management practices

P12 Identify opportunities for additional burial places, whilst maintaining Rookwood wide values- heritage, social, visual, vegetation and ecological.

12.1 The area has not been buried previously and is all allocated for burial.

SD 2 Protect Rookwood's heritage and conserve its environment

P 1 Maintain Visual Corridors:

1.1 Soften views into Lot 10 by providing/reinforcing boundary planting.

P8 Maintain significant trees/vegetation/ botanical items of rarity- refer Significant Tree Register:

- 8.1 Maintain Vegetation Conservation Areas in accordance with PMP. Manage area in association with adjacent areas in Unit 22.
- 8.2 Undertake accurate and respectful implementation of religious requirements in tree planting and management actions.
- 8.3 Tree management needs to take account of the Jewish law Halacha that determines where trees are to be planted and maintained.

SD 4 Respect cultural diversity and equitable allocation of resources



P11 Maintain representative examples of social/religious group burial practices-areas identified in social significance study:

- 11.1 This area has been allocated to the Muslim and Jewish communities for burial.
- 11.2 Respect the autonomy and individuality of each faith in all activities.

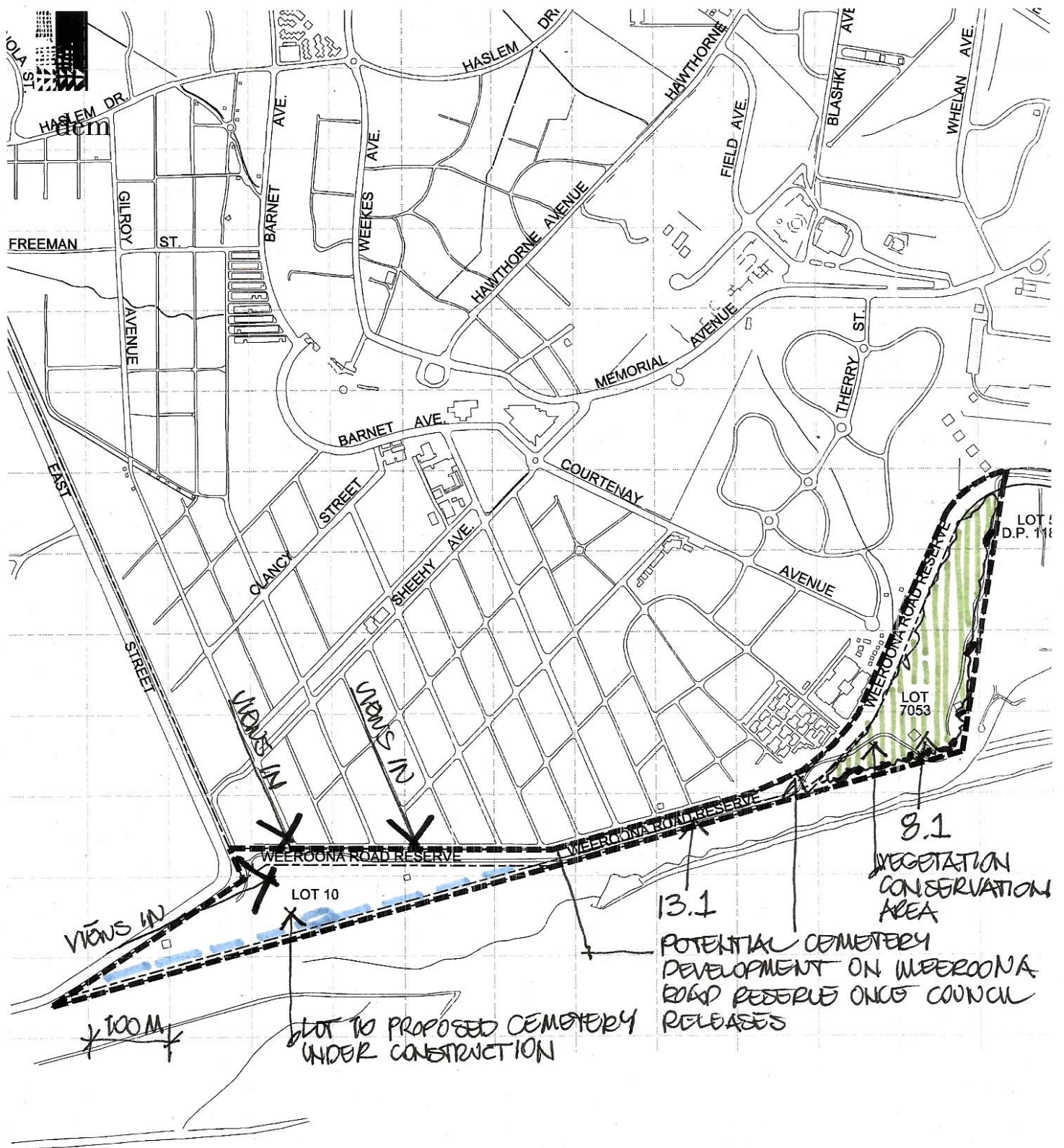

Unit 24

Rookwood Necropolis